

This drawing contains proprietary information owned or controlled by RPVisual Solutions and must not be used or disclosed without prior written authorization

DIMENSIONS ARE IN INCHES
TOLERANCES ARE:
FRACTIONS: X/X : ± 1/32
DECIMALS: .XX : ± .03
 .XXX : ± .010
ANGLES: X : ± .5
 .XX : ± .20

APPROVED FOR FABRICATION
SIGNATURE: _____

DATE: _____

NOTES:
1. FINISH: MATTE BLACK PC
2. TOTAL WEIGHT (APPROXIMATE): 84 LBS

G			
F			
E			
C			
B			
A			
REV:	DESCRIPTION:	BY:	DATE:
DEALER:			

PROJECT: _____

SKU: RPWM-32B-XM-TNV

PART NO: _____

DESCRIPTION: THIN X-ARM 32B KIT

SIZE: B DATE: 3/18/2021 DRAWN: HN CHECKED: XXX

DWG. ID: RPWM-32B-XM-TNV.1

JOB NO: _____ SCALE: 1:8
SHEET: 1 OF 4 REVISION: B

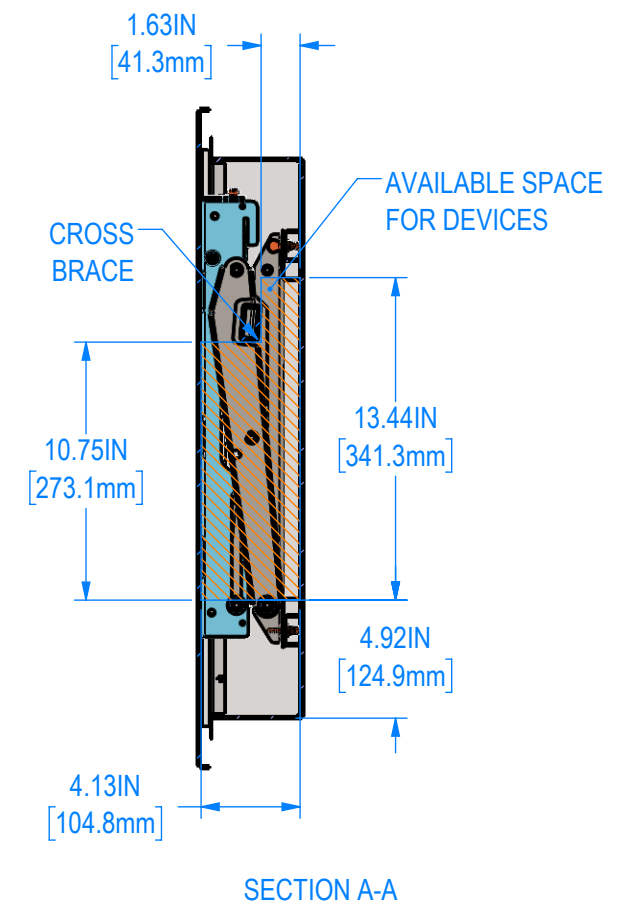
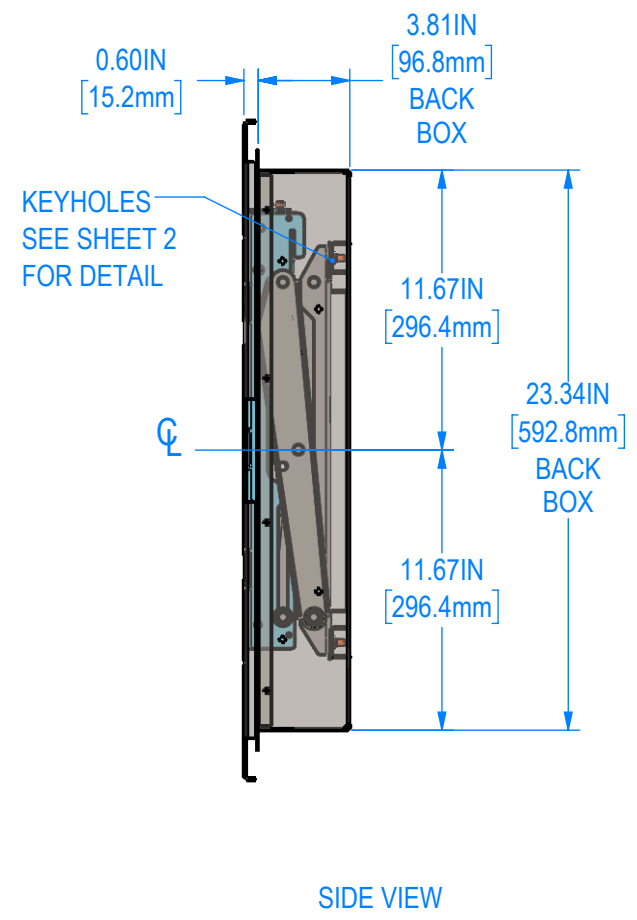
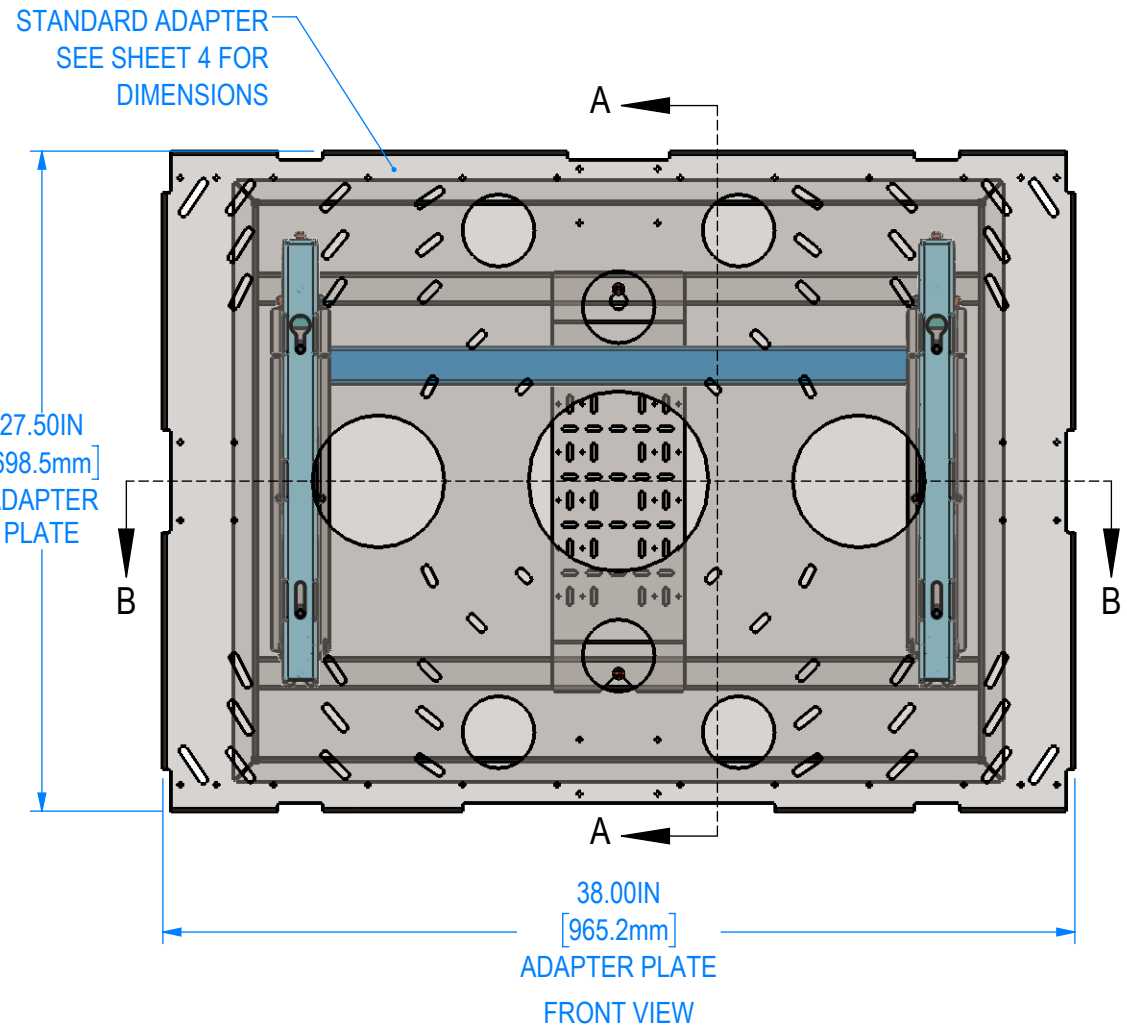
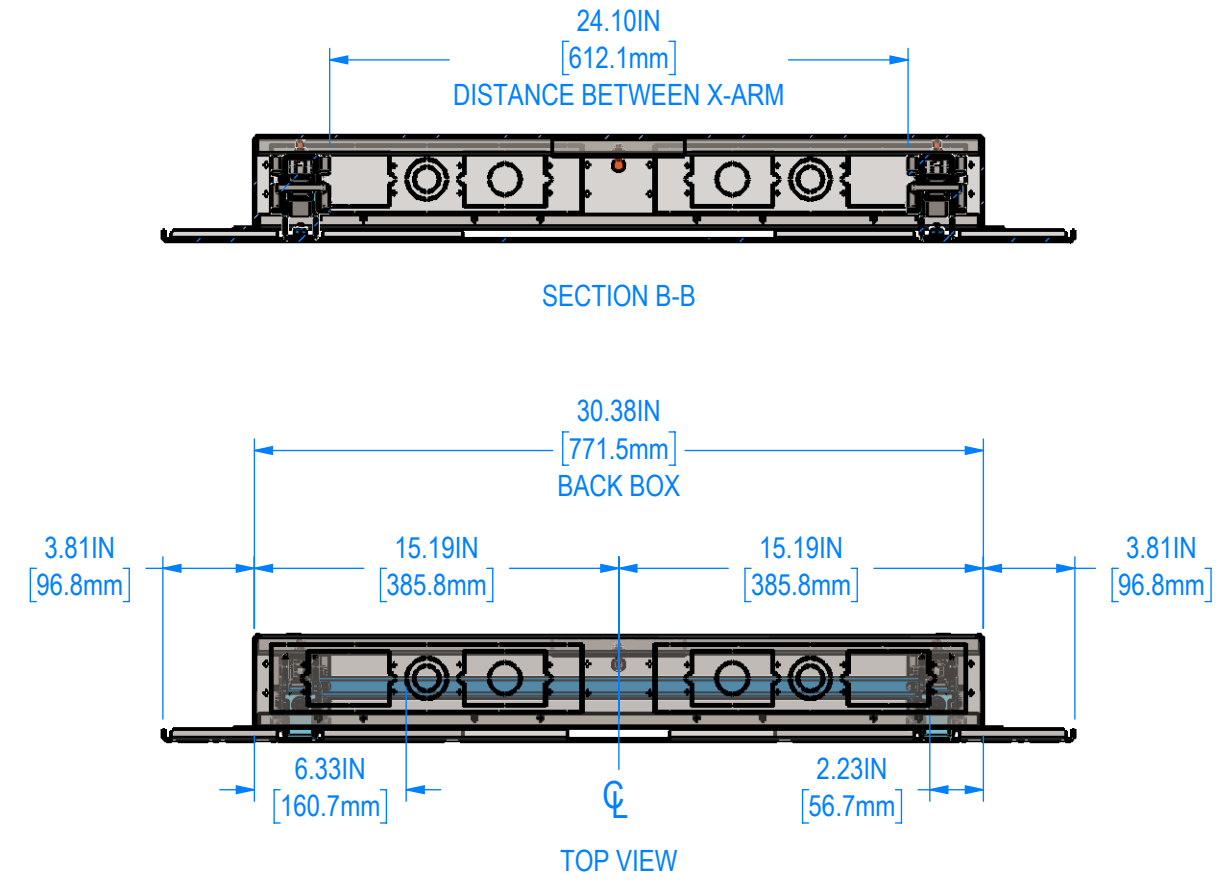
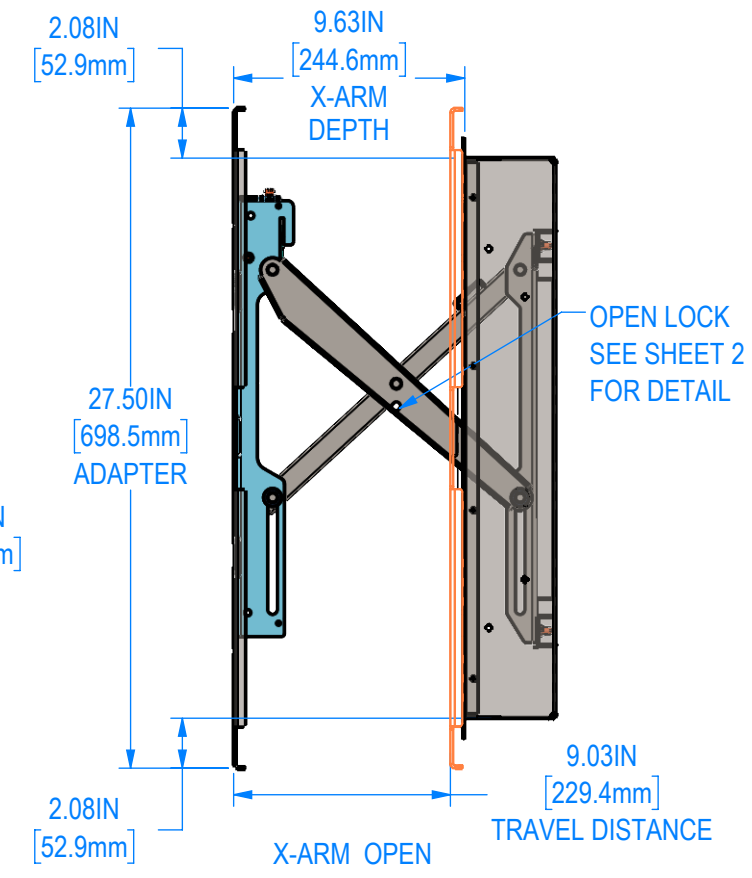
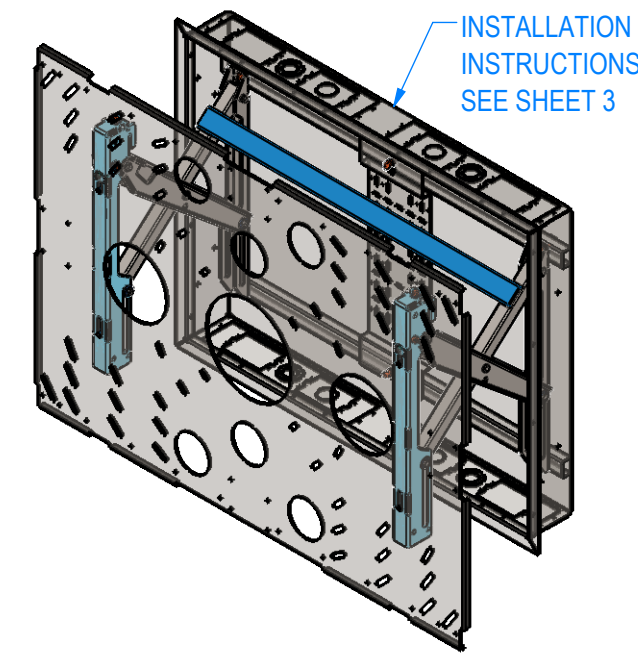

This drawing contains proprietary information owned or controlled by RPVisual Solutions and must not be used or disclosed without prior written authorization

DIMENSIONS ARE IN INCHES
 TOLERANCES ARE:
 FRACTIONS DECIMALS ANGLES
 X/X : ± 1/32 .XX : ± .03 .X : ± .5
 .XXX : ± .010 .XX : ± .20

APPROVED FOR FABRICATION

SIGNATURE:

DATE:

NOTES:

G			
F			
E			
C			
B			
A			

REV: DESCRIPTION: BY: DATE:
 DEALER:

PROJECT:

SKU:

RPWM-32B-XM-TNV

PART NO:

DESCRIPTION:

THIN X-ARM 32B KIT

SIZE: B	DATE: 3/18/2021	DRAWN: HN	CHECKED: XXX
---------	-----------------	-----------	--------------

DWG. ID: RPWM-32B-XM-TNV.2

JOB NO:	SCALE: 1:6	REVISION:
	SHEET: 2 OF 4	B

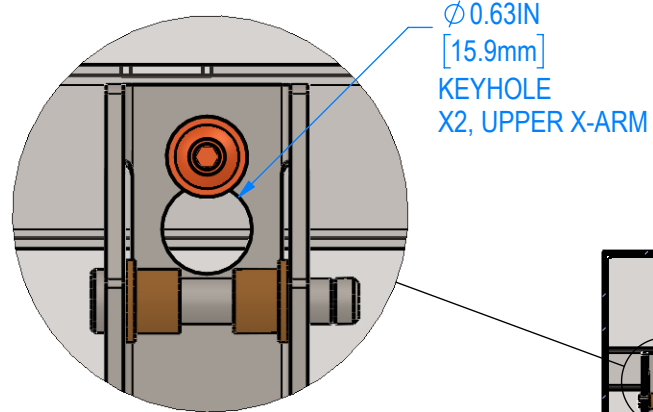

Ø 0.631IN
 [15.9mm]
 KEYHOLE
 X2, UPPER X-ARM

DETAIL D
 SCALE 3 : 4

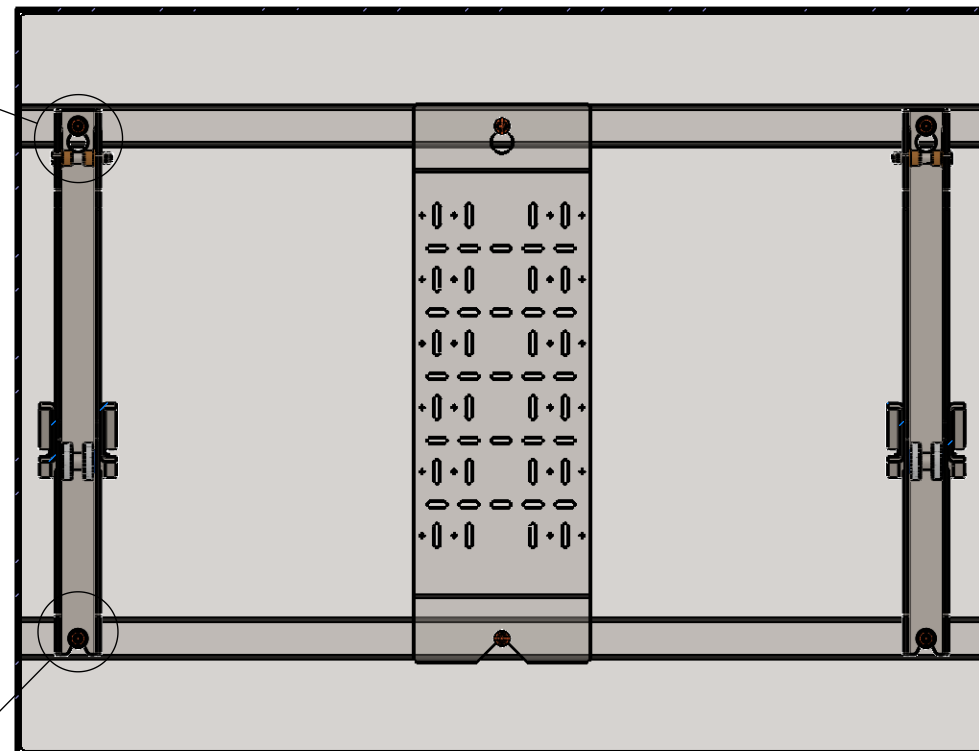

SECTION C-C

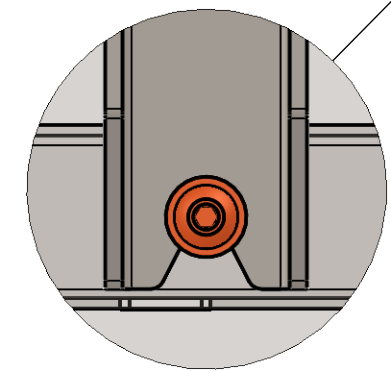

DETAIL E
 SCALE 3 : 4

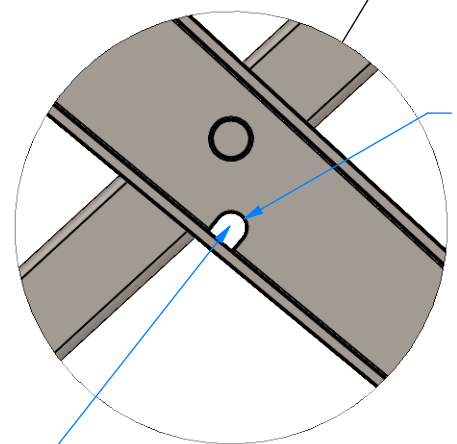

Ø 0.331IN
 [8.4mm]

USE THIS LOCATION
 TO LOCK X-ARM
 IN OPEN POSITION

DETAIL F
 SCALE 1 : 2

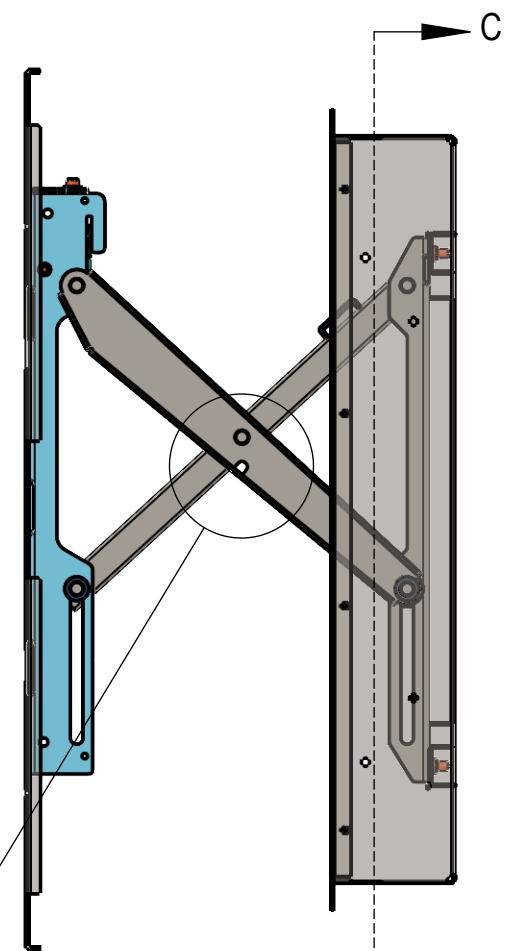

SIDE VIEW
 OPEN POSITION

This drawing contains proprietary information owned or controlled by RPVisual Solutions and must not be used or disclosed without prior written authorization

DIMENSIONS ARE IN INCHES

TOLERANCES ARE:

FRACTIONS	DECIMALS	ANGLES
X/X : ± 1/32	.XX : ± .03 .XXX : ± .010	X : ± .5 .XX : ± .20

APPROVED FOR FABRICATION

SIGNATURE: _____

DATE: _____

NOTES:

1. FINISH: MATTE BLACK PC
2. TOTAL WEIGHT (APPROXIMATE): 84 LBS

G			
F			
E			
C			
B			
A			

REV: DESCRIPTION: _____ BY: _____ DATE: _____

DEALER: _____

PROJECT: _____

SKU: RPWM-32B-XM-TNV

PART NO: _____

DESCRIPTION: THIN X-ARM 32B KIT

SIZE: B	DATE: 3/18/2021	DRAWN: HN	CHECKED: XXX
---------	-----------------	-----------	--------------

DWG. ID: RPWM-32B-XM-TNV.3

JOB NO:	SCALE: 1:9	REVISION: B
	SHEET: 3 OF 4	

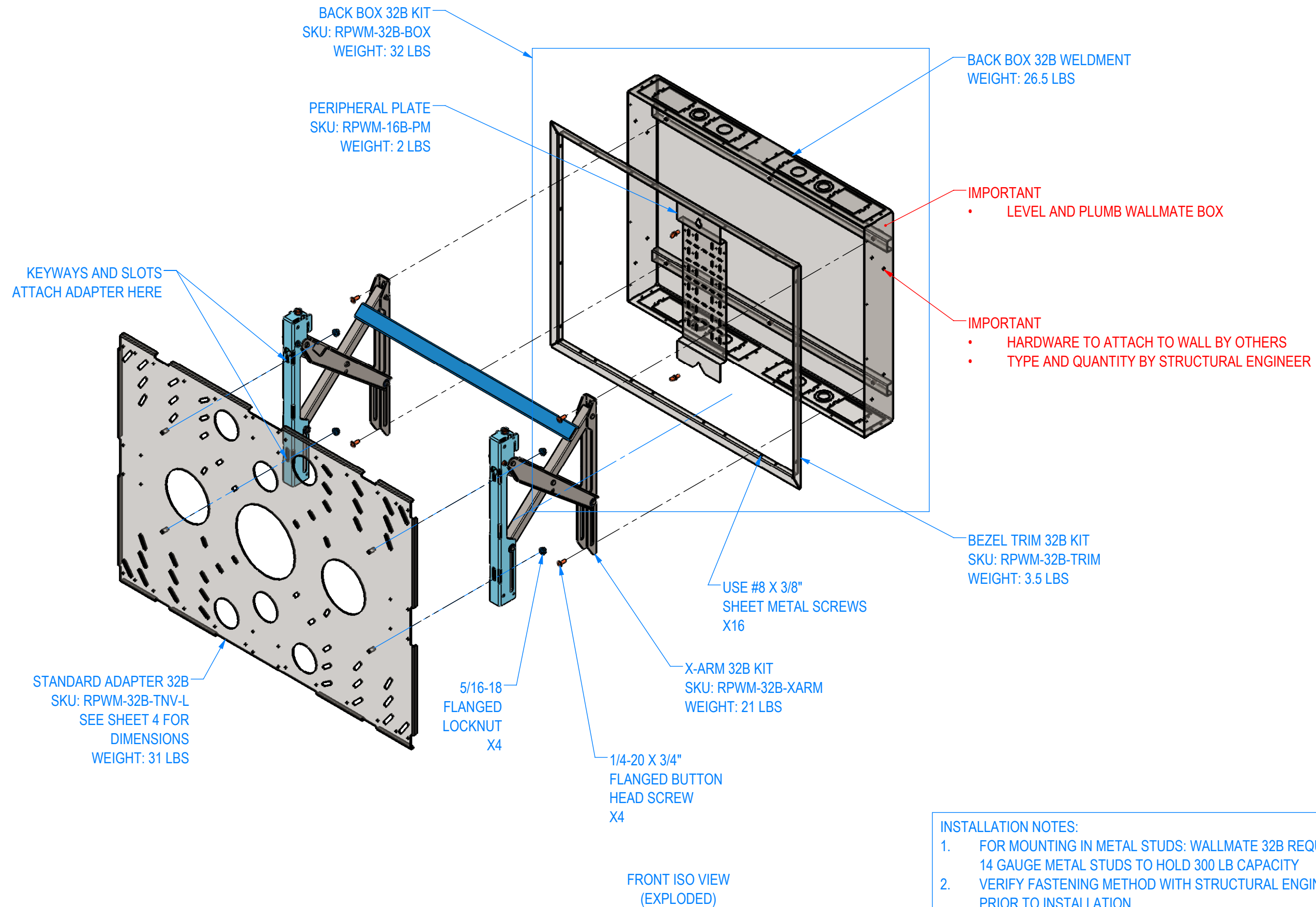

- INSTALLATION NOTES:**
1. FOR MOUNTING IN METAL STUDS: WALLMATE 32B REQUIRES 14 GAUGE METAL STUDS TO HOLD 300 LB CAPACITY
 2. VERIFY FASTENING METHOD WITH STRUCTURAL ENGINEER PRIOR TO INSTALLATION
 3. VERIFY WALL STRENGTH PRIOR TO INSTALLATION
 4. USE ALL FASTENING POINTS ON BOTH SIDES OF BOX

NOTE TO CONTRACTOR:
 USE SUPPLIED HARDWARE WITH CAUTION:
 - SCREWS CAN EXCEED DISPLAY INSERT LENGTH
 - VERIFY INSERT LENGTH WITH DISPLAY
 MANUFACTURER PRIOR TO USE

DISPLAY MOUNTING HARDWARE PROVIDED BY RPV:
 QTY: 4 / UNIT - M6 X 16mm FLANGED SBHCS ALLOY
 QTY: 4 / UNIT - M8 X 16mm, M8 X 20mm FLANGED SBHCS ALLOY
 QTY: 4 / UNIT - M8 X 40mm SBHCS ALLOY
 QTY: 4 / UNIT - 5/16" ID X 3/4" OD FLAT WASHER

This drawing contains proprietary information owned or controlled by RPVisual Solutions and must not be used or disclosed without prior written authorization

DIMENSIONS ARE IN INCHES
 TOLERANCES ARE:
 FRACTIONS: X/X : ± 1/32
 DECIMALS: .XX : ± .03
 .XXX : ± .010
 ANGLES: X : ± .5
 .XX : ± .20

APPROVED FOR FABRICATION
 SIGNATURE:

DATE:

NOTES:
 1. FINISH: SEMI-GLOSS BLACK POWDER COAT
 2. APPROXIMATE WEIGHT: 30.78

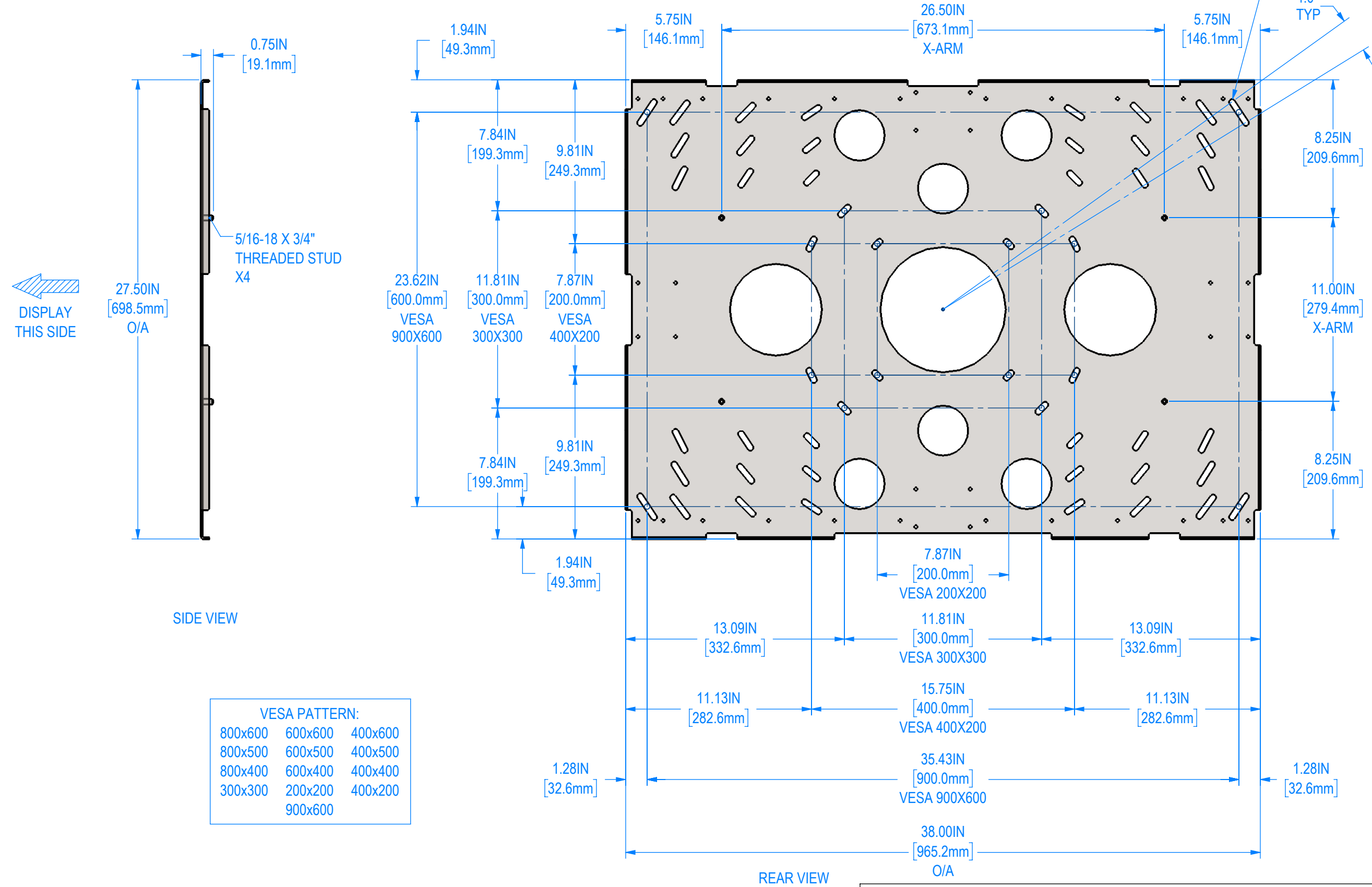

VESA PATTERN:

800x600	600x600	400x600
800x500	600x500	400x500
800x400	600x400	400x400
300x300	200x200	400x200
	900x600	

G			
F			
E			
C			
B			
A			
REV:	DESCRIPTION:	BY:	DATE:
DEALER:			

PROJECT:

SKU: RPWM-32B-TNV-L

PART NO:

DESCRIPTION: STD ADAPTER 32B LANDSCAPE

SIZE: B	DATE: 3/18/2021	DRAWN: HN	CHECKED: XXX
---------	-----------------	-----------	--------------

DWG. ID: RPWM-32B-XM-TNV.4