

SECTION B-B

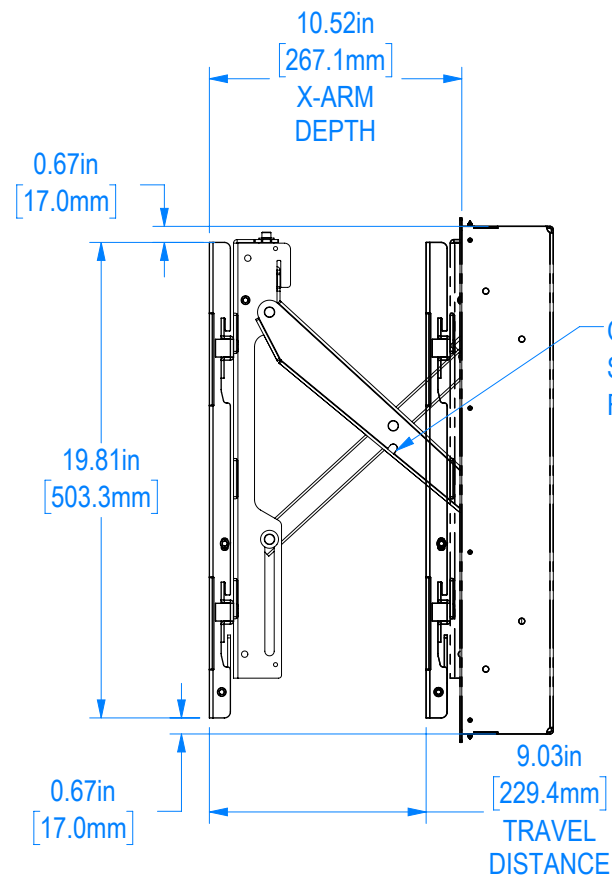

X-ARM OPEN

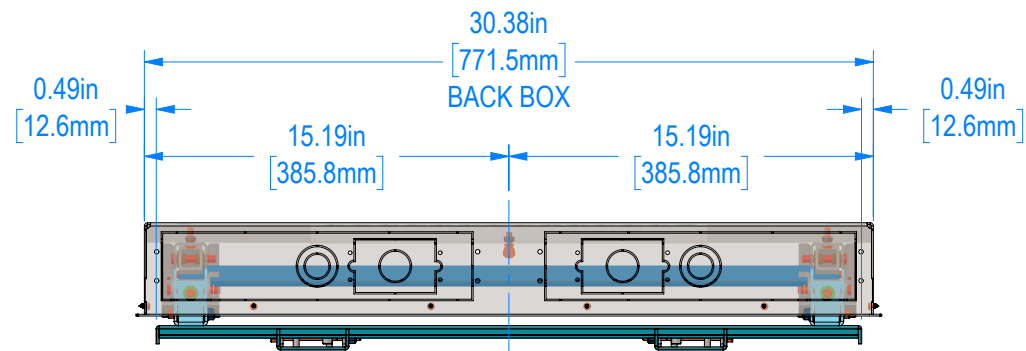
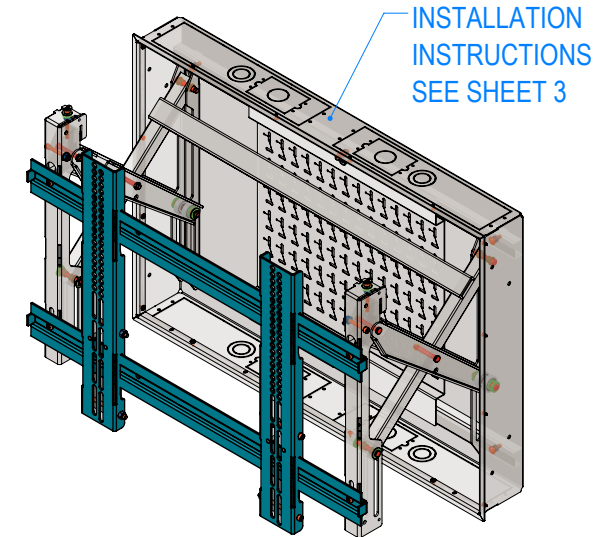

TOP VIEW

WALLMATE UNIVERSAL MOUNTING INTERFACE
SEE SHEET 4 FOR DIMENSIONS

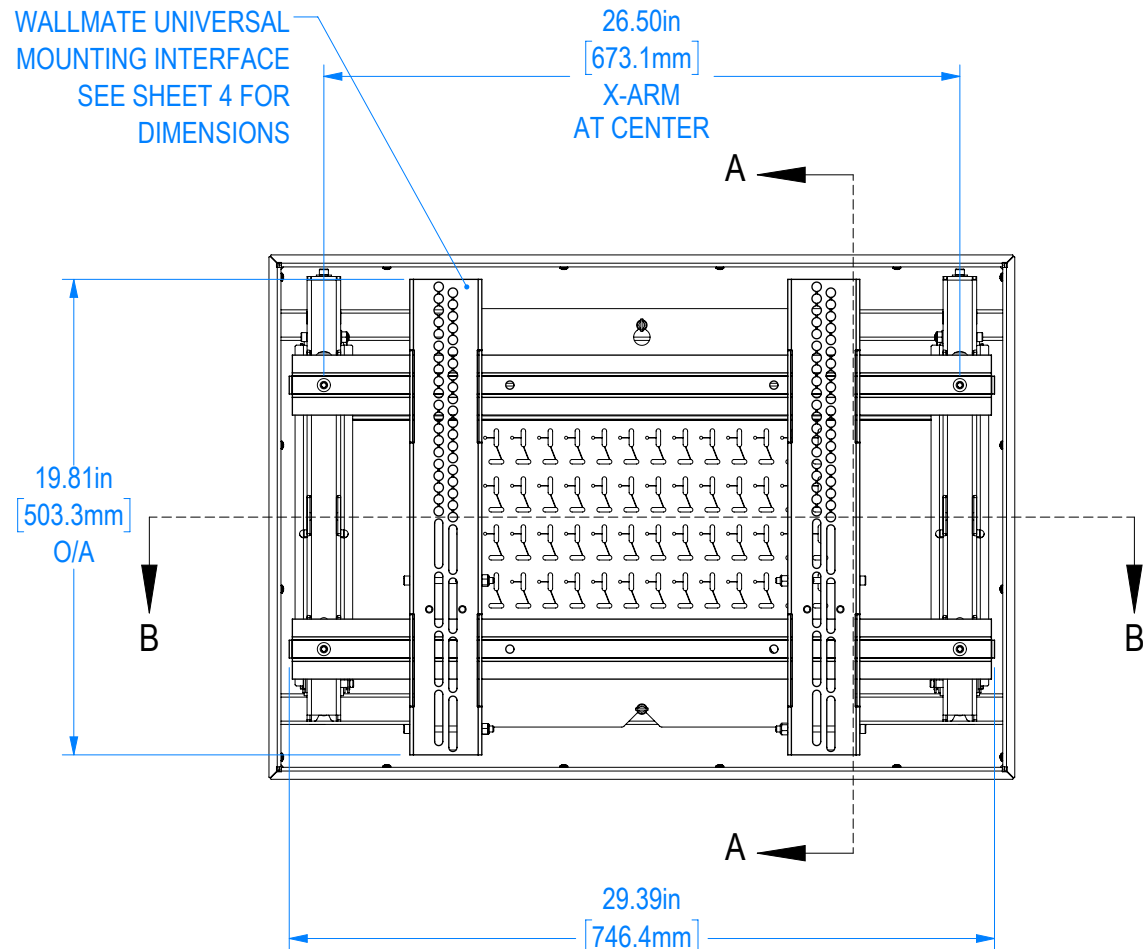

FRONT VIEW

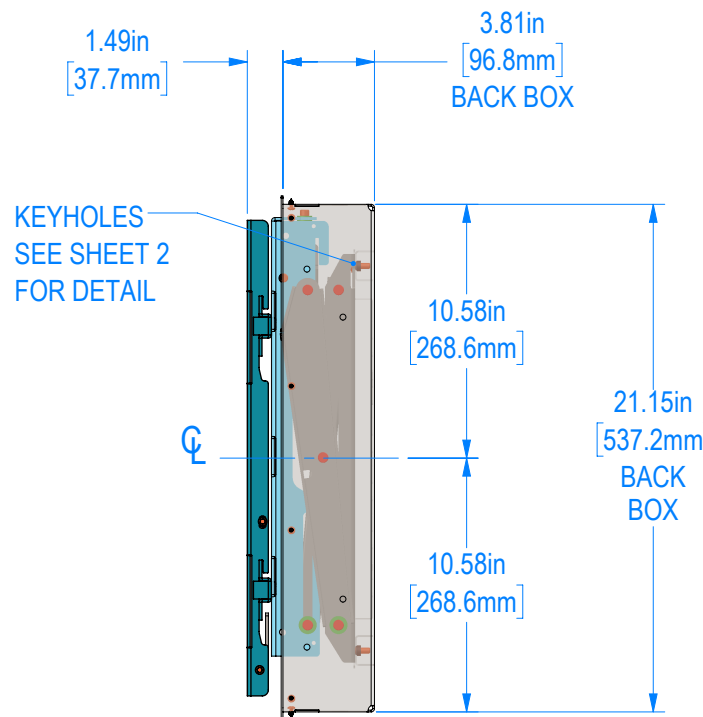

SIDE VIEW

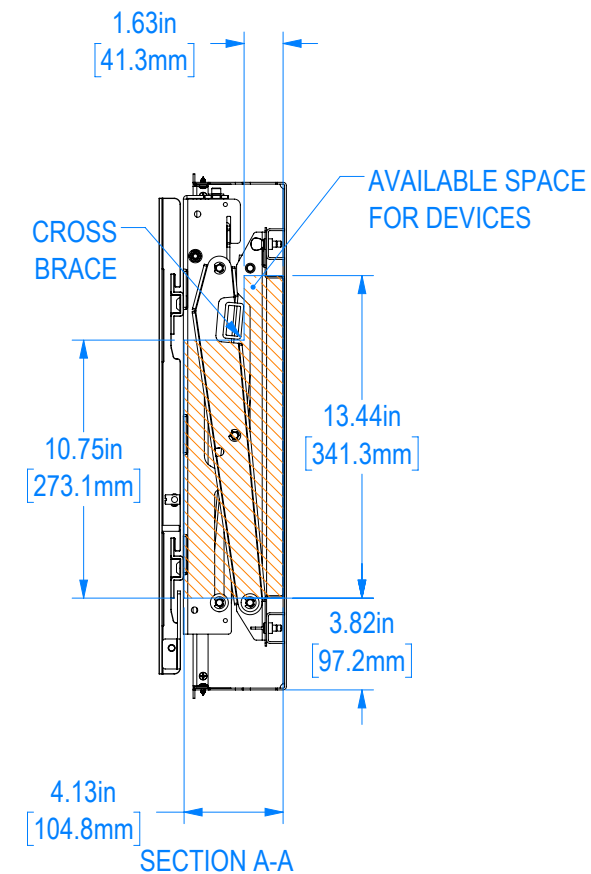

SECTION A-A

DIMENSIONS ARE IN INCHES

TOLERANCES ARE:

FRACTIONS	DECIMALS	ANGLES
X/X : ± 1/32	.XX : ± .03 .XXX : ± .010	X : ± .5 .XX : ± .20

APPROVED FOR FABRICATION

SIGNATURE:

DATE:

NOTES:

1. FINISH: SEMI-GLOSS BLACK POWDER COAT
2. TOTAL WEIGHT (APPROXIMATE): 65.13 LBS

G			
F			
E			
C			
B			
A			

REV:	DESCRIPTION:	BY:	DATE:
DEALER:			

PROJECT:

SKU: RPWM-3220-XM-UNV

PART NO:

DESCRIPTION: UNV X-ARM KIT 3220

SIZE: B	DATE: 11/9/2022	DRAWN: AT	CHECKED: XXX
---------	-----------------	-----------	--------------

DWG. ID: RPWM-3220-XM-UNV.1

JOB NO:	SCALE: 1:8	REVISION:
	SHEET: 1 OF 4	

This drawing contains proprietary information owned or controlled by RPVisual Solutions and must not be used or disclosed without prior written authorization

DIMENSIONS ARE IN INCHES

TOLERANCES ARE:

FRACTIONS	DECIMALS	ANGLES
X/X : ± 1/32	.XX : ± .03 .XXX : ± .010	.X : ± .5 .XX : ± .20

APPROVED FOR FABRICATION

SIGNATURE: _____

DATE: _____

NOTES:

1. FINISH: SEMI-GLOSS BLACK POWDER COAT
2. TOTAL WEIGHT (APPROXIMATE): 65.13 LBS

G			
F			
E			
C			
B			
A			

REV: DESCRIPTION: _____ BY: _____ DATE: _____

DEALER: _____

PROJECT: _____

SKU: **RPWM-3220-XM-UNV**

PART NO: _____

DESCRIPTION: **UNV X-ARM KIT 3220**

SIZE: B	DATE: 11/9/2022	DRAWN: AT	CHECKED: XXX
----------------	------------------------	------------------	---------------------

DWG. ID: **RPWM-3220-XM-UNV.2**

JOB NO:	SCALE: 1:6	REVISION:
	SHEET: 2 OF 4	

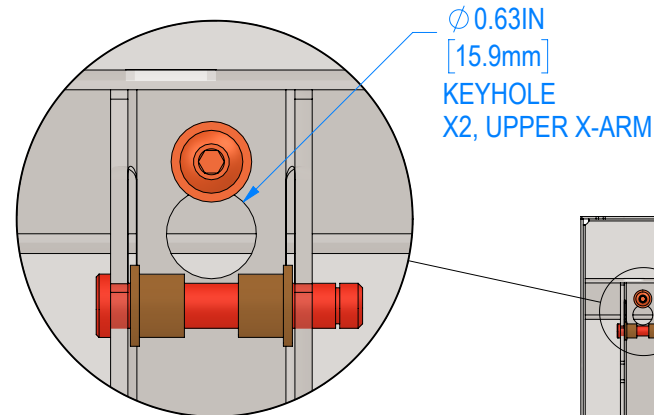

DETAIL D
SCALE 3 : 4

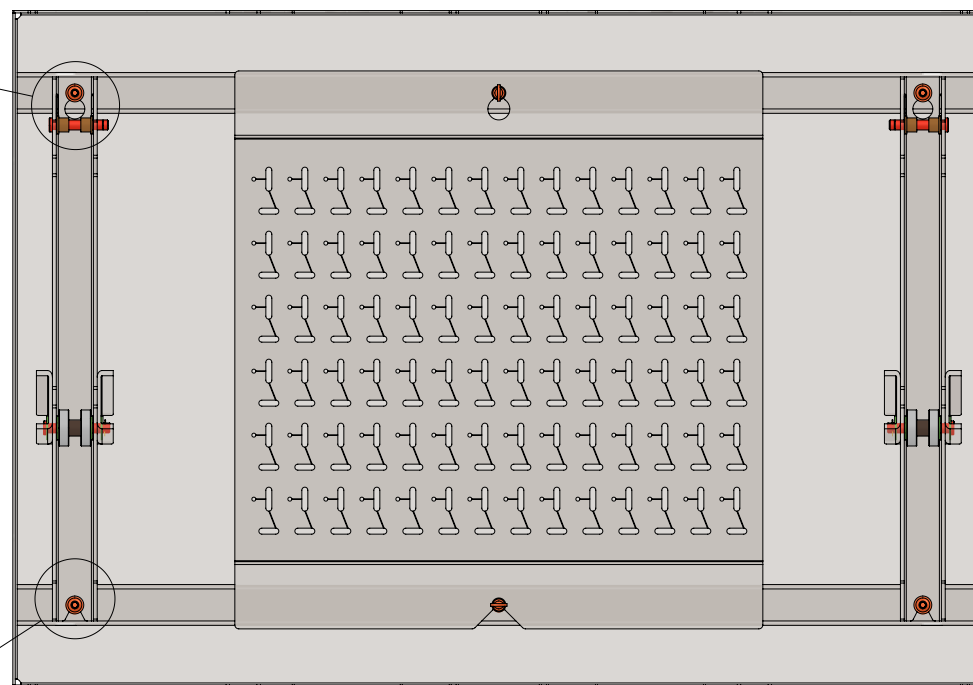

SECTION C-C

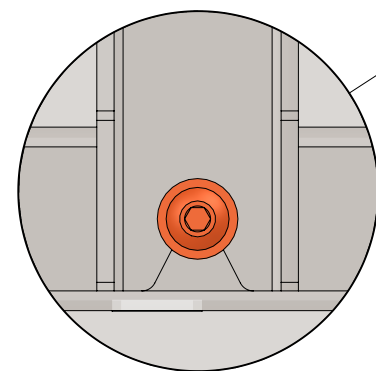

DETAIL E
SCALE 3 : 4

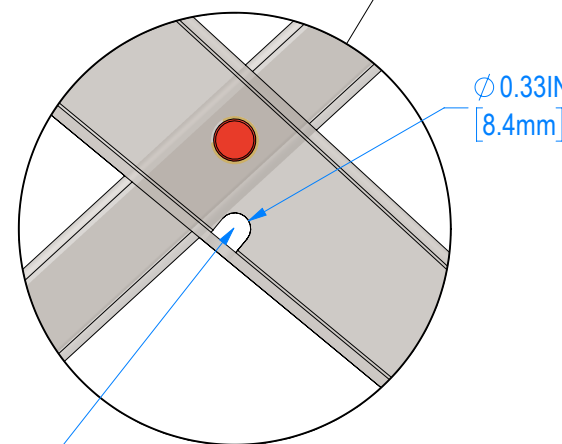

DETAIL F
SCALE 1 : 2

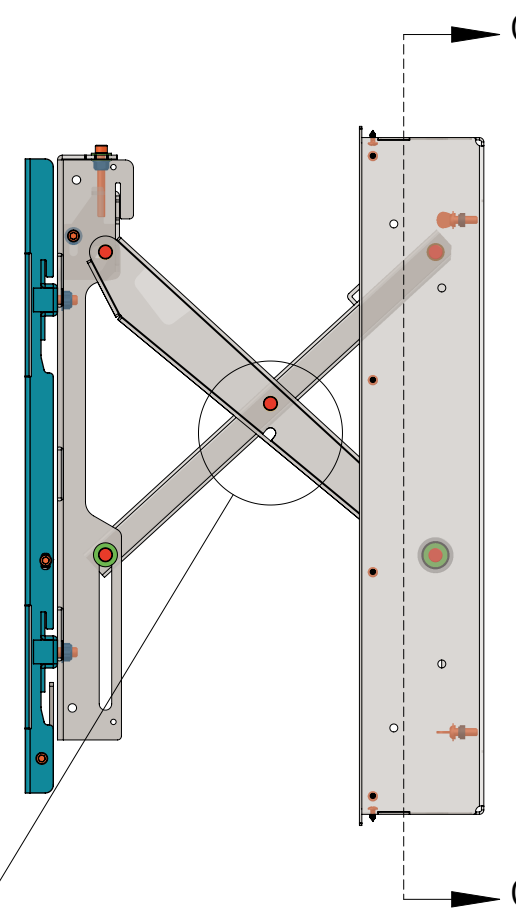

SIDE VIEW
OPEN POSITION

This drawing contains proprietary information owned or controlled by RPVisual Solutions and must not be used or disclosed without prior written authorization

DIMENSIONS ARE IN INCHES
TOLERANCES ARE:
FRACTIONS: X/X : ± 1/32
DECIMALS: .XX : ± .03
 .XXX : ± .010
ANGLES: X : ± .5
 .XX : ± .20

APPROVED FOR FABRICATION

SIGNATURE:

DATE:

NOTES:

1. FINISH: SEMI-GLOSS BLACK POWDER COAT
2. TOTAL WEIGHT (APPROXIMATE): 65.13 LBS

G			
F			
E			
C			
B			
A			

REV: DESCRIPTION: BY: DATE:

DEALER:

PROJECT:

SKU: RPWM-3220-XM-UNV

PART NO:

DESCRIPTION: UNV X-ARM KIT 3220

SIZE: B	DATE: 11/9/2022	DRAWN: AT	CHECKED: XXX
---------	-----------------	-----------	--------------

DWG. ID: RPWM-32BM-XM-UNV.3

JOB NO:	SCALE: 1:9	REVISION:
	SHEET: 3 OF 4	

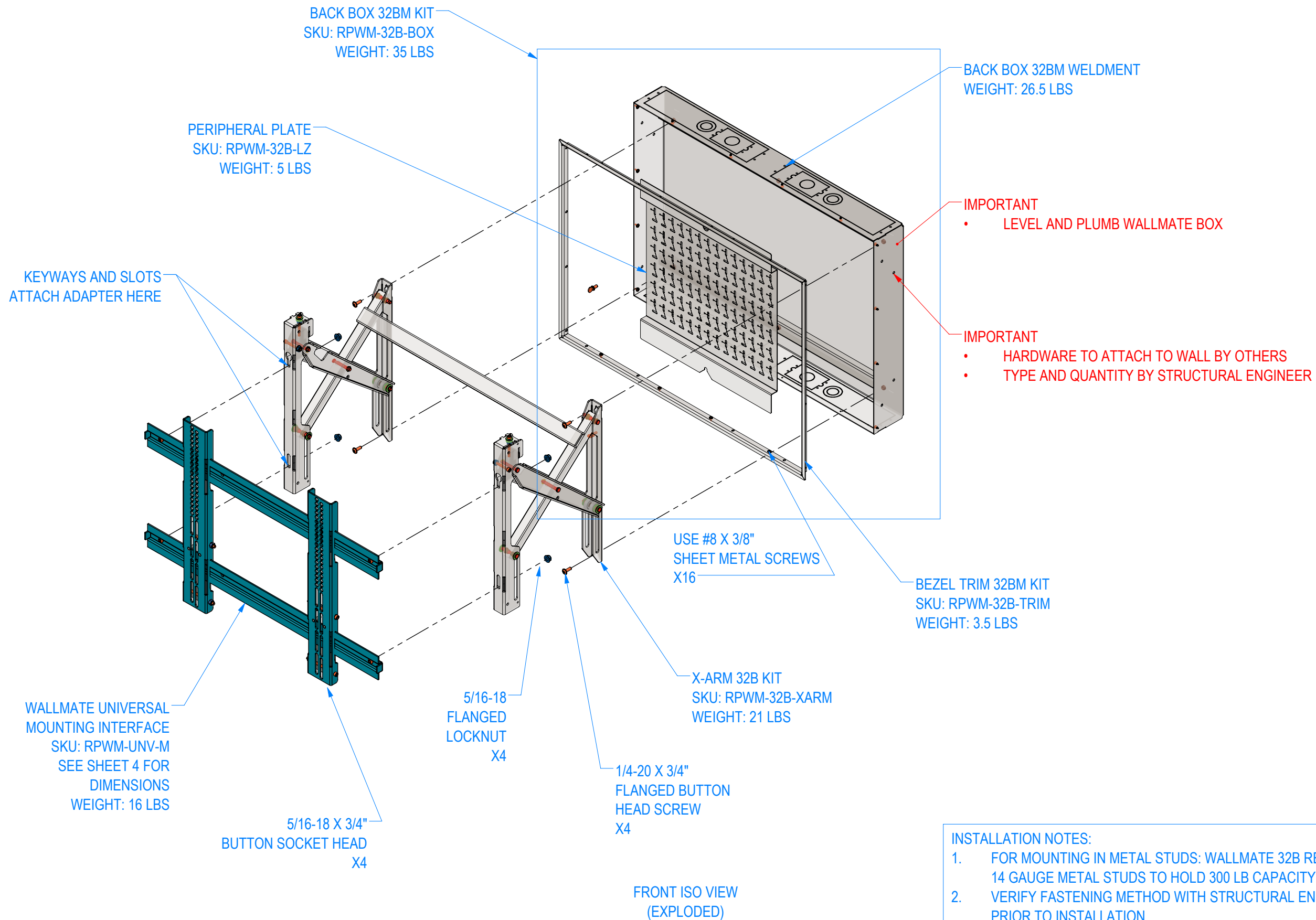

- INSTALLATION NOTES:
1. FOR MOUNTING IN METAL STUDS: WALLMATE 32B REQUIRES 14 GAUGE METAL STUDS TO HOLD 300 LB CAPACITY
 2. VERIFY FASTENING METHOD WITH STRUCTURAL ENGINEER PRIOR TO INSTALLATION
 3. VERIFY WALL STRENGTH PRIOR TO INSTALLATION
 4. USE ALL FASTENING POINTS ON BOTH SIDES OF BOX

NOTE TO CONTRACTOR:
 USE SUPPLIED HARDWARE WITH CAUTION:
 - SCREWS CAN EXCEED DISPLAY INSERT LENGTH
 - VERIFY INSERT LENGTH WITH DISPLAY
 MANUFACTURER PRIOR TO USE

DISPLAY MOUNTING HARDWARE PROVIDED BY RPV:
 QTY: 4 / UNIT - M6 X 16mm FLANGED SBHCS ALLOY
 QTY: 4 / UNIT - M8 X 16mm, M8 X 20mm FLANGED SBHCS ALLOY
 QTY: 4 / UNIT - M8 X 40mm SBHCS ALLOY
 QTY: 4 / UNIT - 5/16" ID X 3/4" OD FLAT WASHER

This drawing contains proprietary information owned or controlled by RPVisual Solutions and must not be used or disclosed without prior written authorization

DIMENSIONS ARE IN INCHES
 TOLERANCES ARE:
 FRACTIONS: X/X : ± 1/32 DECIMALS: .XX : ± .03 ANGLES: X : ± .5
 .XXX : ± .010 .XX : ± .20

APPROVED FOR FABRICATION
 SIGNATURE:

DATE:

NOTES:
 1. FINISH: SEMI-GLOSS BLACK POWDER COAT
 2. TOTAL WEIGHT (APPROXIMATE): 13 LBS

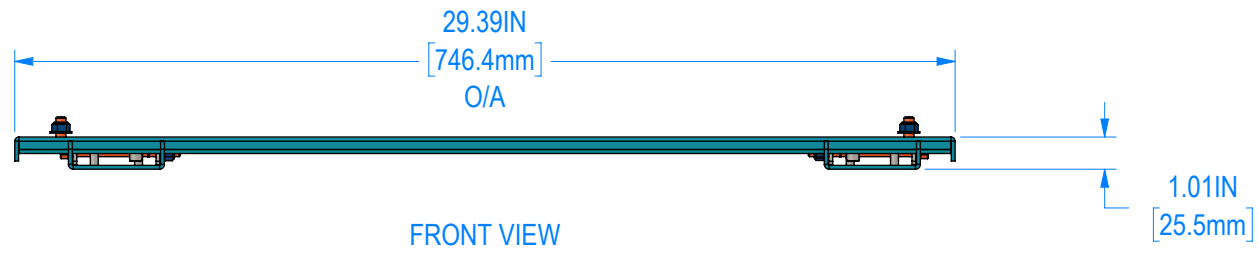

←
 DISPLAY THIS SIDE

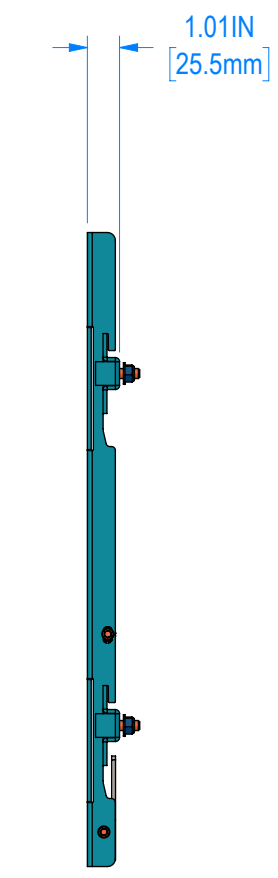
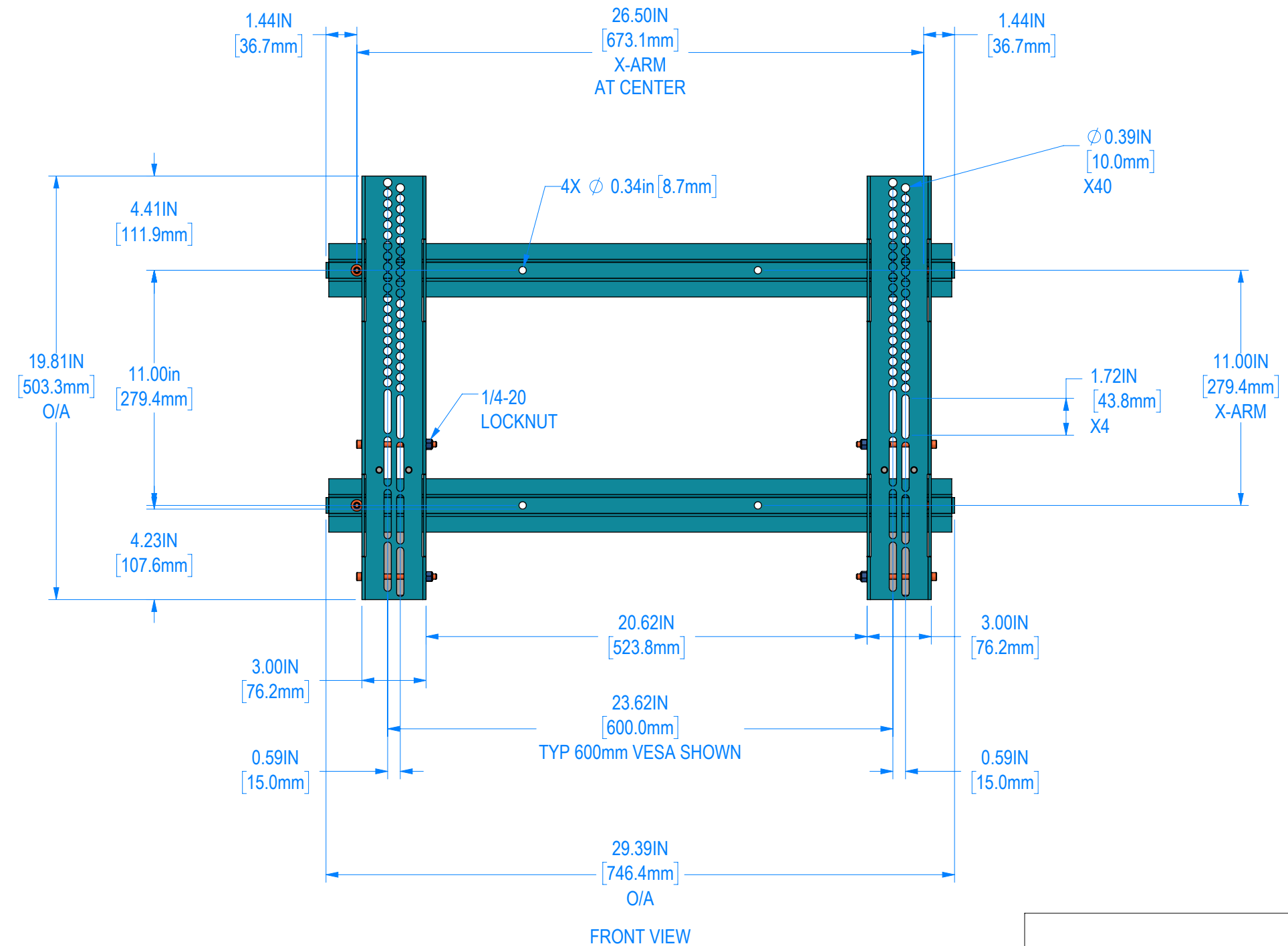

SIDE VIEW

G			
F			
E			
C			
B			
A			
REV:	DESCRIPTION:	BY:	DATE:
DEALER:			

PROJECT:

SKU: **RPWM-UNV-M**

PART NO:

DESCRIPTION:
UNIVERSITY ADAPTER KIT M

SIZE: B	DATE: 11/9/2022	DRAWN: AT	CHECKED: XXX
----------------	-----------------	-----------	--------------

DWG. ID: **RPWM-32BM-XM-UNV.4**

SKU: RPWM-UNV-M	JOB NO:	SCALE: 1:6	REVISION:
		SHEET: 4 OF 4	