

This drawing contains proprietary information owned or controlled by RPVisual Solutions and must not be used or disclosed without prior written authorization

DIMENSIONS ARE IN INCHES
TOLERANCES ARE:

FRACTIONS	DECIMALS	ANGLES
X/X : ± 1/32	.XX : ± .03 .XXX : ± .010	X : ± .5 .XX : ± .20

APPROVED FOR FABRICATION
SIGNATURE: _____

DATE: _____

NOTES:
1. FINISH: SEMI-GLOSS BLACK POWDER COAT
2. APPROXIMATE WEIGHT: 90.02 LBS

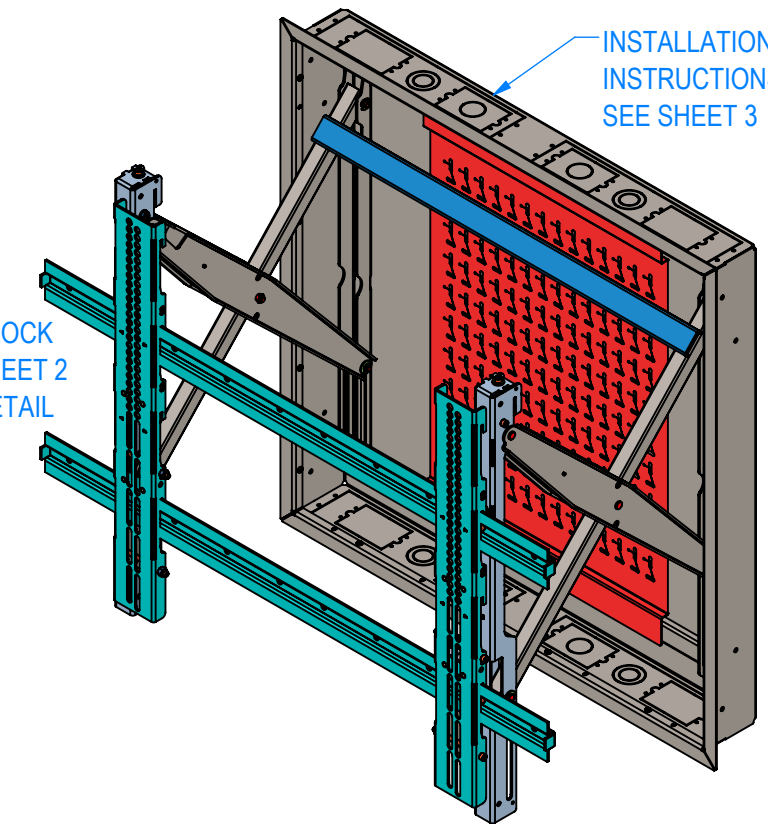

ISOMETRIC VIEW
SCALE 1 : 10

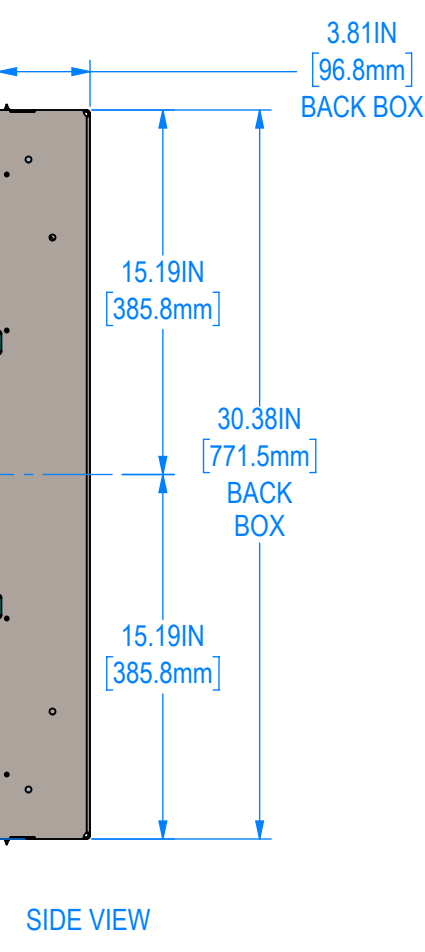
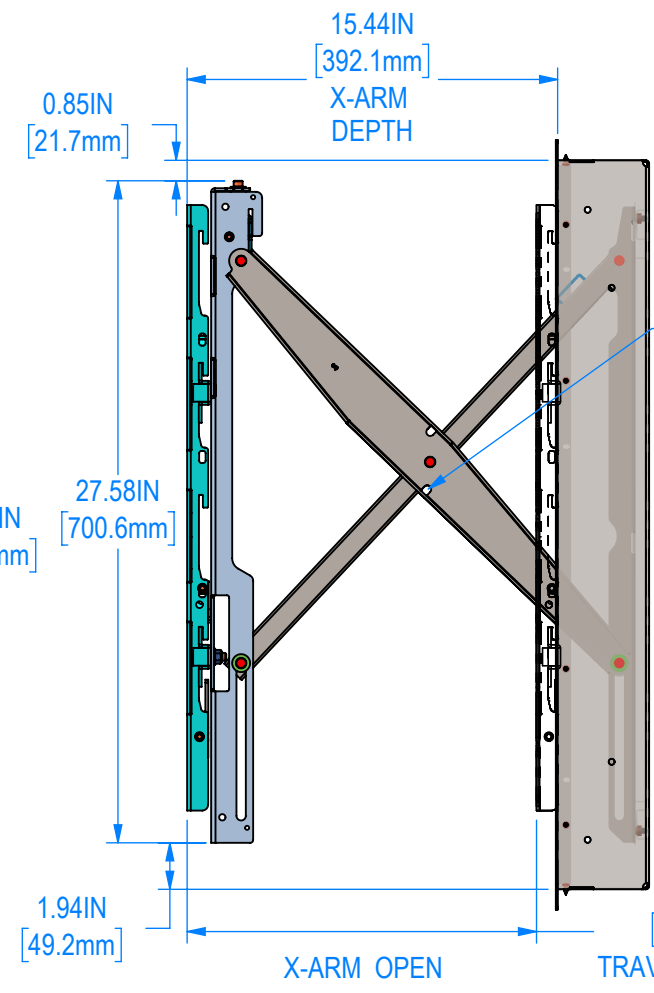

SIDE VIEW

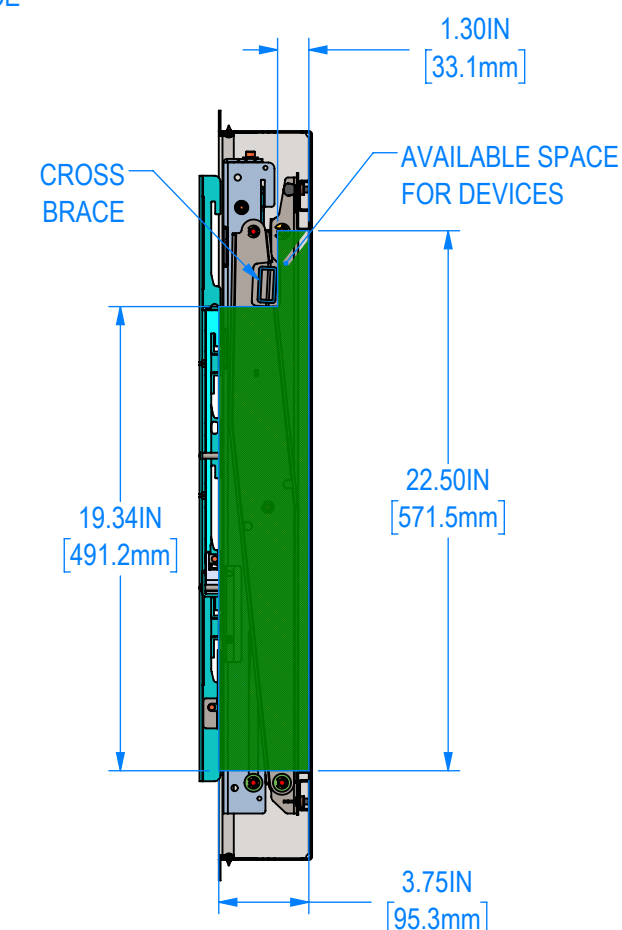

SECTION A-A

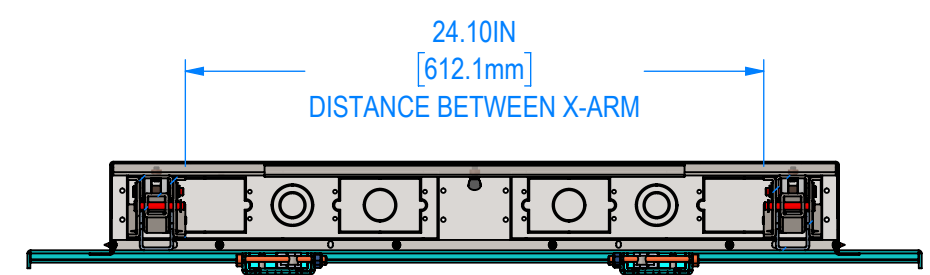

SECTION B-B

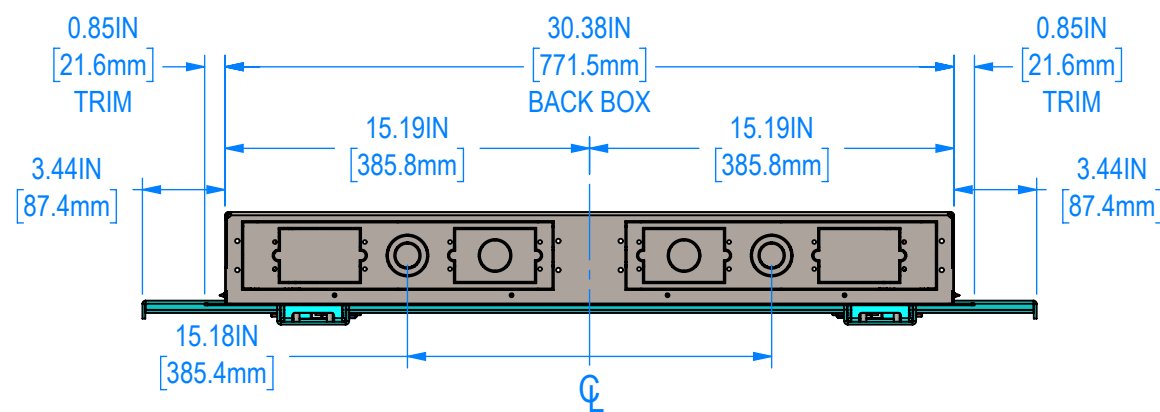

TOP VIEW

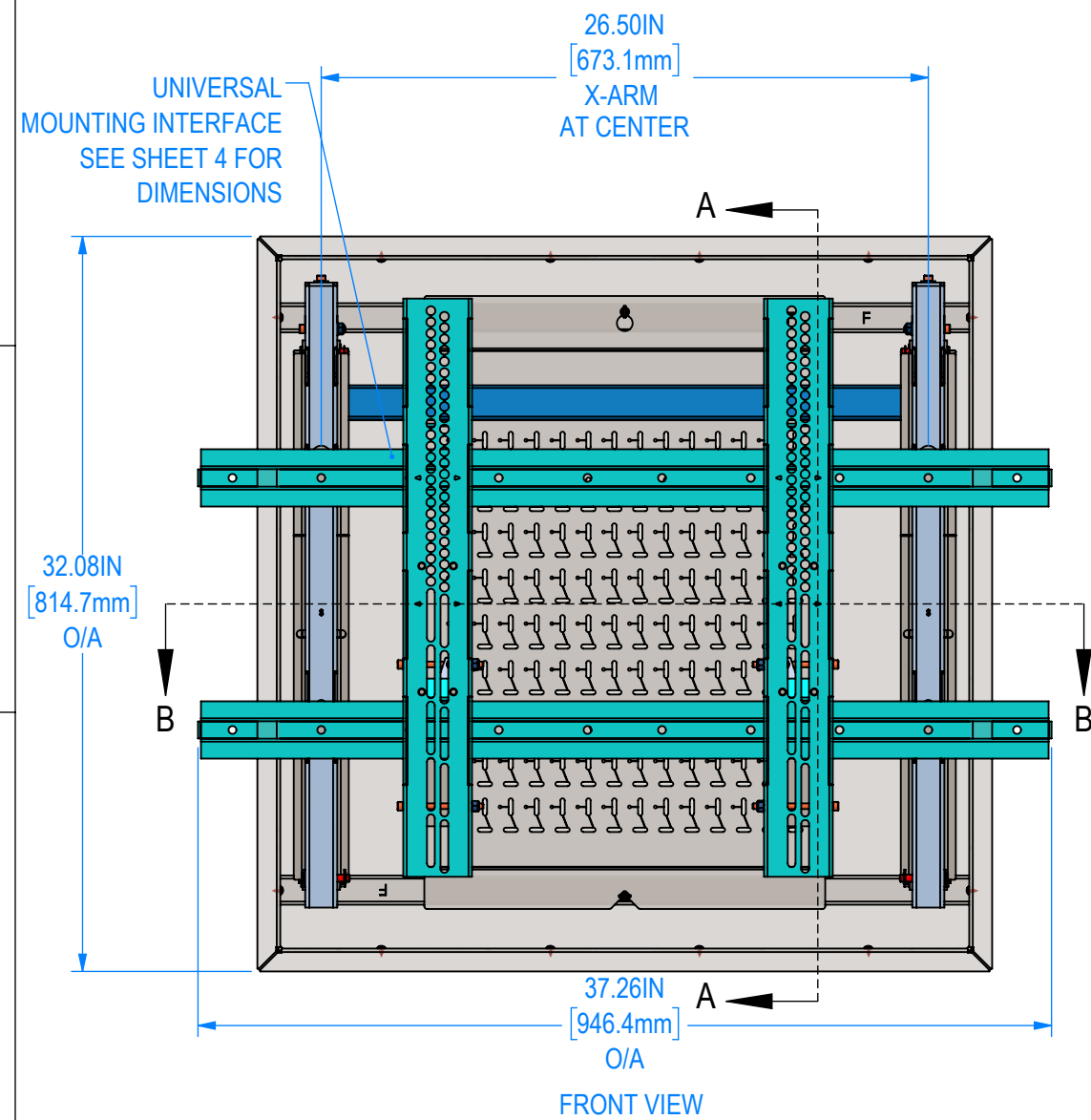

FRONT VIEW

This drawing contains proprietary information owned or controlled by RPVisual Solutions and must not be used or disclosed without prior written authorization

DIMENSIONS ARE IN INCHES

TOLERANCES ARE:

FRACTIONS	DECIMALS	ANGLES
X/X : ± 1/32	.XX : ± .03 .XXX : ± .010	.X : ± .5 .XX : ± .20

APPROVED FOR FABRICATION

SIGNATURE: _____

DATE: _____

NOTES:

G			
F			
E			
C			
B			
A			

REV: DESCRIPTION: _____ BY: _____ DATE: _____

DEALER: _____

PROJECT: _____

SKU: **RPWM-32MAXBF-XMS-UNV**

PART NO: **0003-140-00**

DESCRIPTION: **UNIVERSAL MOUNT-
PULL OUT WALLMATE
32MAXBF KIT**

SIZE: B	DATE: 9/18/2023	DRAWN: GS	CHECKED: XXX
----------------	------------------------	------------------	---------------------

DWG. ID: **RPWM-32MAXBF-XMS-UNV.2**

JOB NO:	SCALE: 1:6	REVISION:
	SHEET: 2 OF 4	

Ø 0.63IN
[15.9mm]
KEYHOLE X2,
UPPER X-ARM

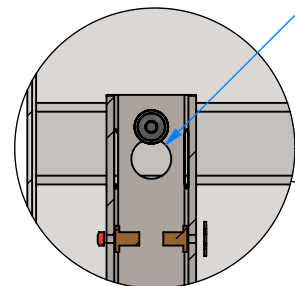

DETAIL D
SCALE 1:3

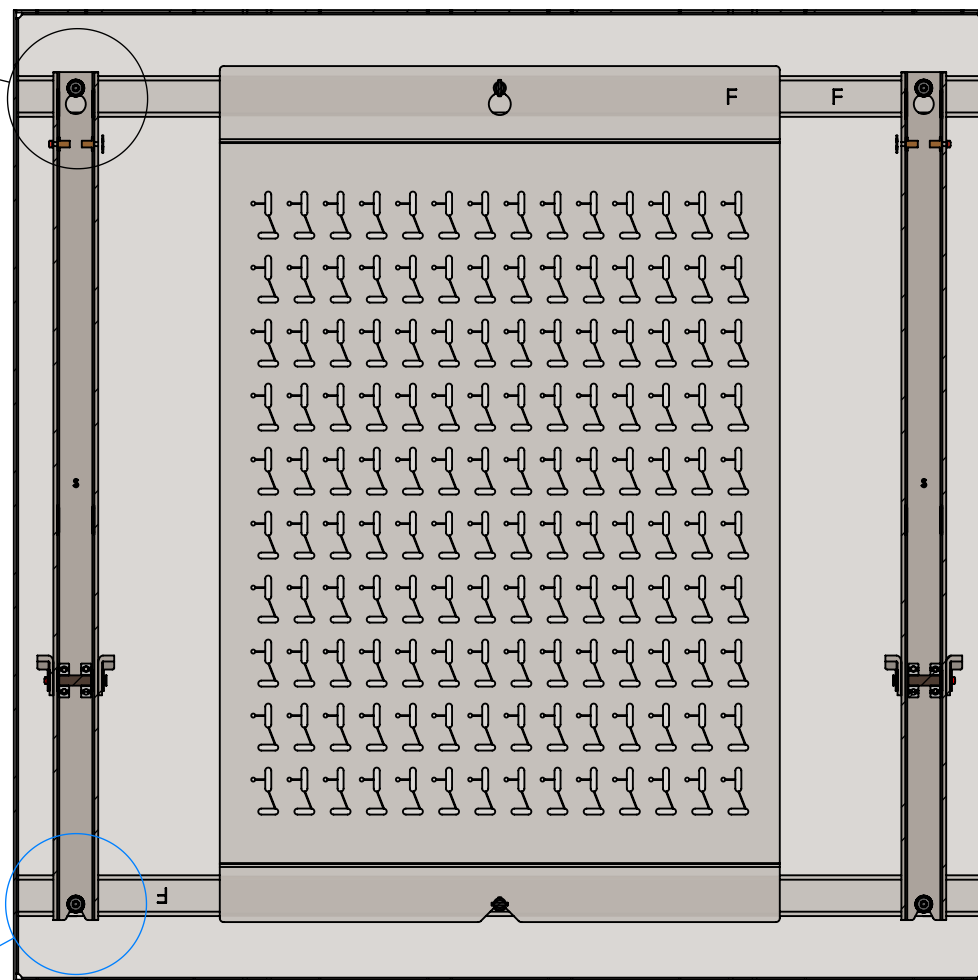

SECTION C-C

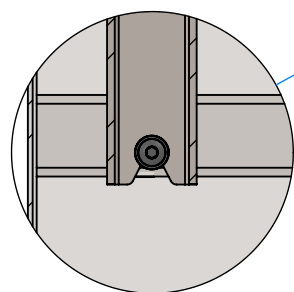

DETAIL E
SCALE 1:3

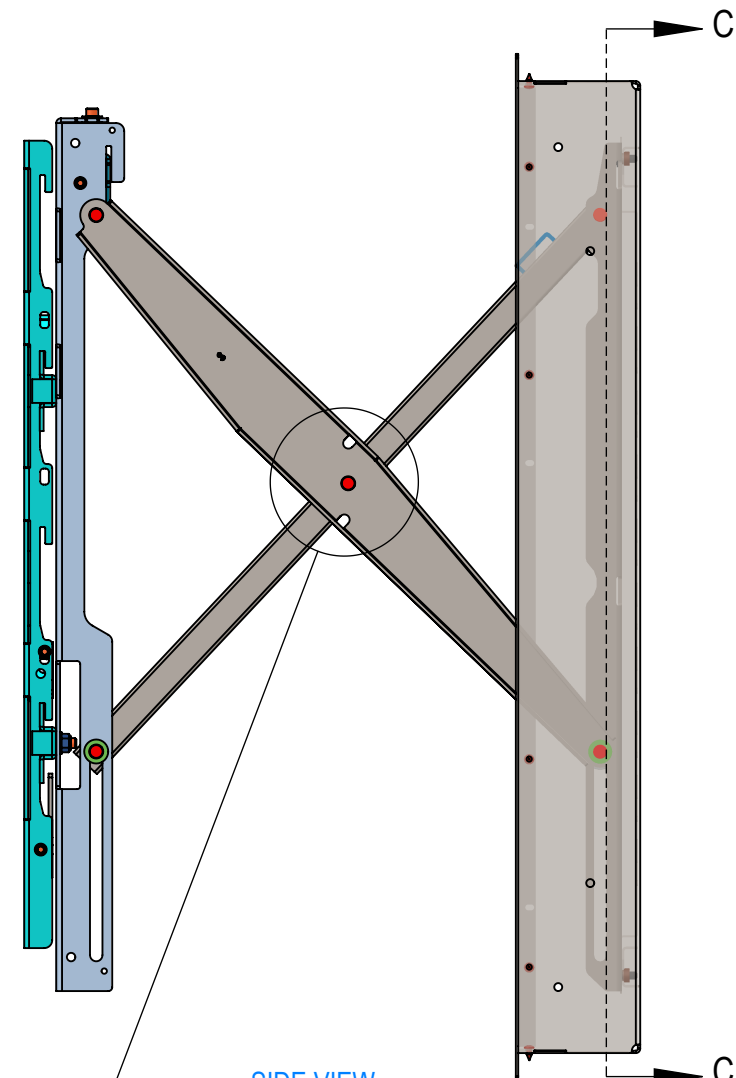

SIDE VIEW
OPEN POSITION

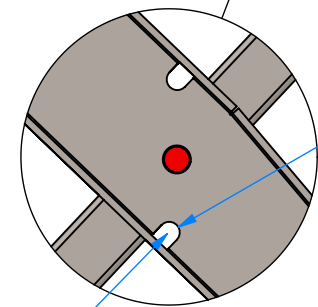

Ø 0.33IN
[8.4mm]

DETAIL F
SCALE 1:3

USE THIS LOCATION
TO LOCK X-ARM
IN OPEN POSITION

This drawing contains proprietary information owned or controlled by RPVisual Solutions and must not be used or disclosed without prior written authorization

DIMENSIONS ARE IN INCHES
 TOLERANCES ARE:
 FRACTIONS: X/X : ± 1/32
 DECIMALS: .XX : ± .03
 .XXX : ± .010
 ANGLES: X : ± .5
 .XX : ± .20

APPROVED FOR FABRICATION

SIGNATURE: _____

DATE: _____

NOTES:

- 1. FINISH: SEMI-GLOSS BLACK POWDER COAT
- 2. APPROXIMATE WEIGHT: 90.02 LBS

G			
F			
E			
C			
B			
A			

REV: DESCRIPTION: _____ BY: _____ DATE: _____
 DEALER: _____

PROJECT: _____

SKU: RPWM-32MAXBF-XMS-UNV

PART NO: 0003-140-00

DESCRIPTION: UNIVERSAL MOUNT-
 PULL OUT WALLMATE
 32MAXBF KIT

SIZE: B	DATE: 9/18/2023	DRAWN: GS	CHECKED: XXX
---------	-----------------	-----------	--------------

DWG. ID: RPWM-32MAXBF-XMS-UNV.3

JOB NO:	SCALE: 1:8	REVISION:
	SHEET: 3 OF 4	

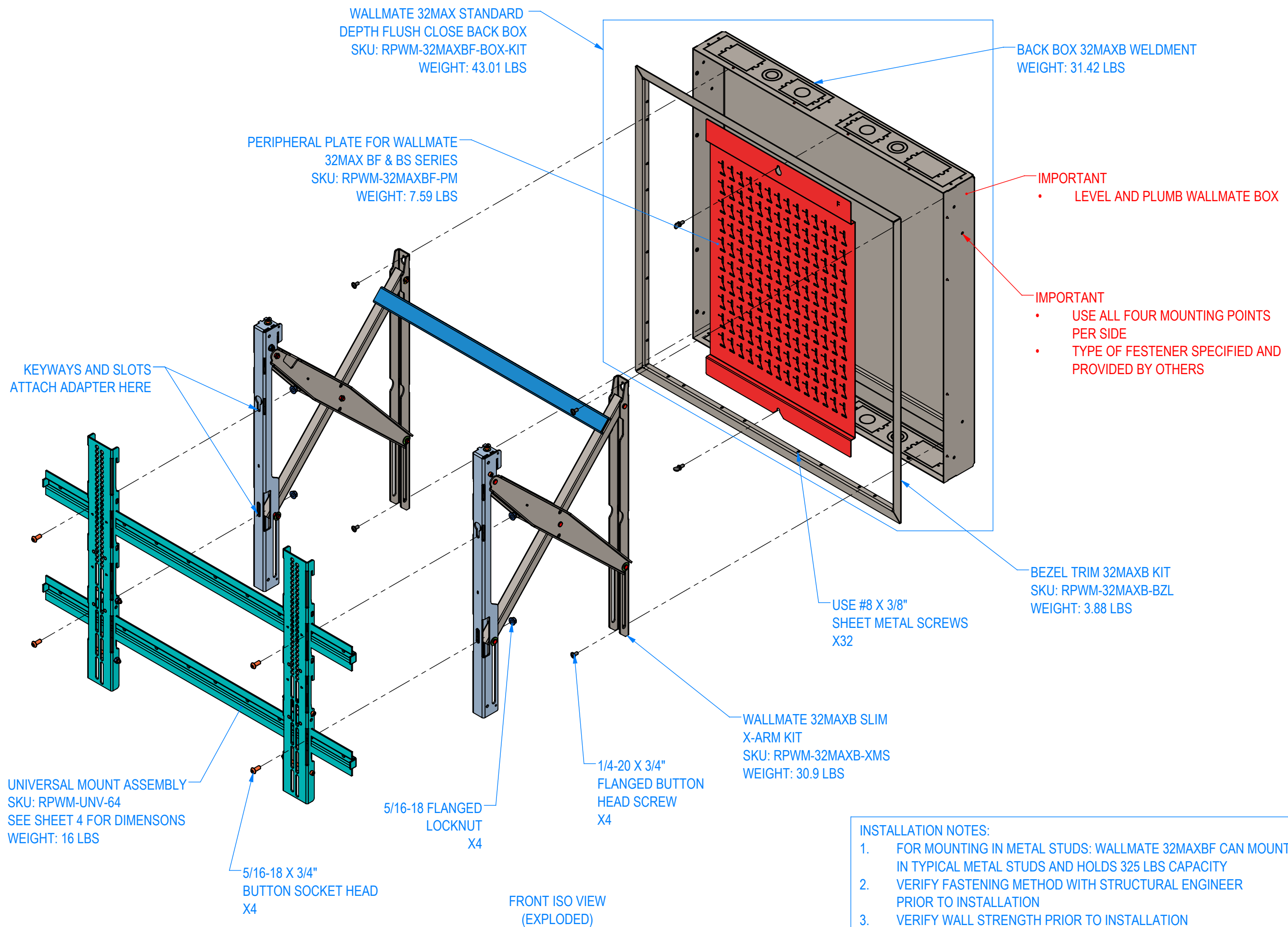

- INSTALLATION NOTES:**
1. FOR MOUNTING IN METAL STUDS: WALLMATE 32MAXBF CAN MOUNT IN TYPICAL METAL STUDS AND HOLDS 325 LBS CAPACITY
 2. VERIFY FASTENING METHOD WITH STRUCTURAL ENGINEER PRIOR TO INSTALLATION
 3. VERIFY WALL STRENGTH PRIOR TO INSTALLATION
 4. USE ALL FASTENING POINTS ON BOTH SIDES OF BOX

NOTE TO CONTRACTOR:
 USE SUPPLIED HARDWARE WITH CAUTION:
 - SCREWS CAN EXCEED DISPLAY INSERT LENGTH
 - VERIFY INSERT LENGTH WITH DISPLAY
 MANUFACTURER PRIOR TO USE

DISPLAY MOUNTING HARDWARE PROVIDED BY RPV:
 QTY: 4 / UNIT - M6 X 16mm FLANGED SBHCS ALLOY
 QTY: 4 / UNIT - M8 X 16mm, M8 X 20mm FLANGED SBHCS ALLOY
 QTY: 4 / UNIT - M8 X 40mm SBHCS ALLOY
 QTY: 4 / UNIT - 5/16" ID X 3/4" OD FLAT WASHER

This drawing contains proprietary information owned or controlled by RPVisual Solutions and must not be used or disclosed without prior written authorization

DIMENSIONS ARE IN INCHES
 TOLERANCES ARE:
 FRACTIONS DECIMALS ANGLES
 X/X : ± 1/32 .XX : ± .03 .X : ± .5
 .XXX : ± .010 .XX : ± .20

APPROVED FOR FABRICATION

SIGNATURE:

DATE:

NOTES:

1. FINISH: SEMI-GLOSS BLACK POWDER COAT
2. TOTAL WEIGHT (APPROXIMATE): 16 LBS

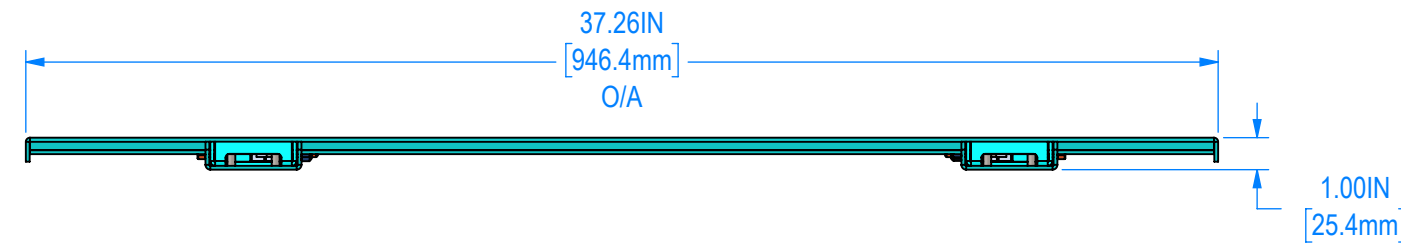

FRONT VIEW



DISPLAY THIS SIDE

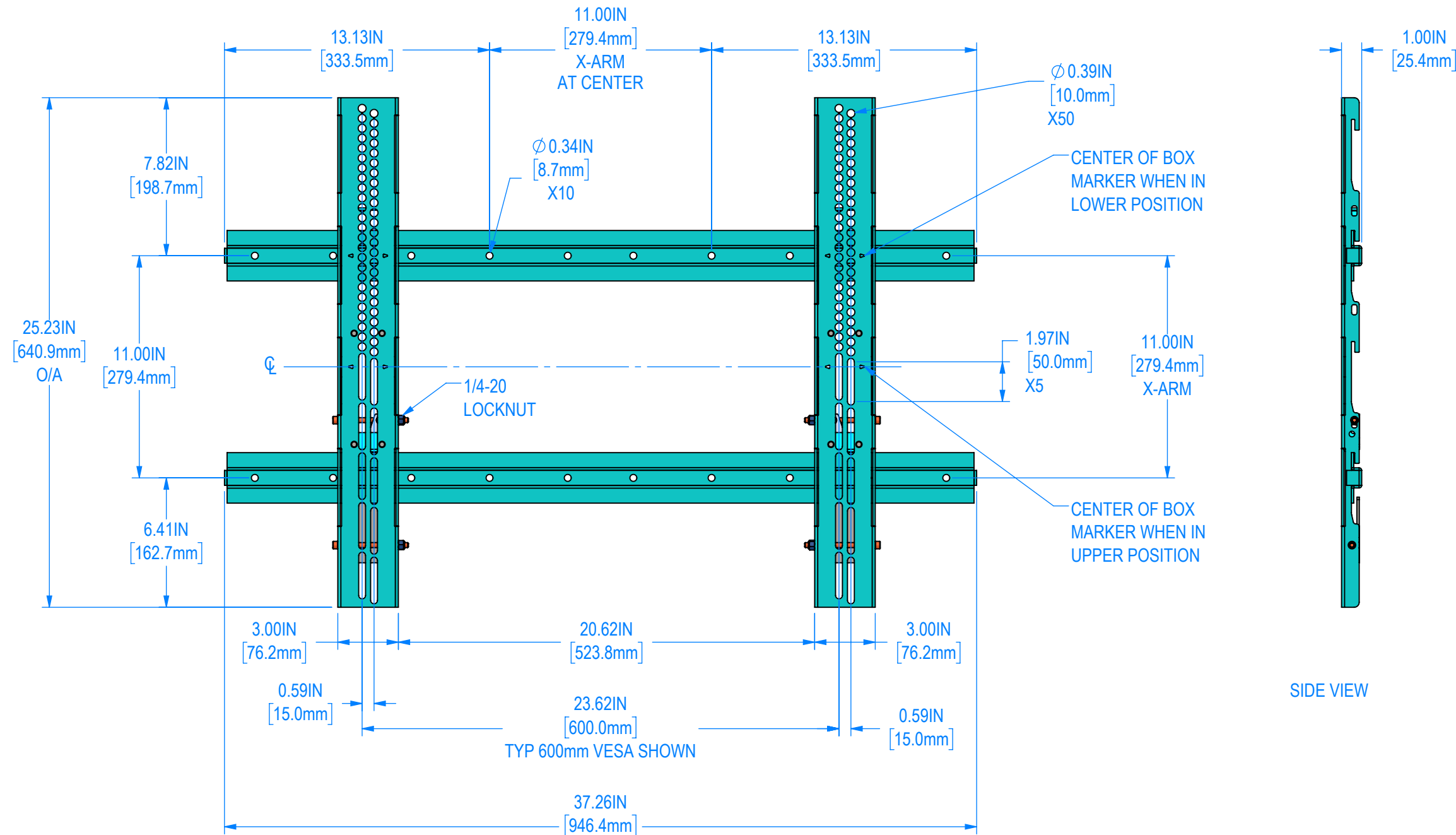

FRONT VIEW

SIDE VIEW

G			
F			
E			
C			
B			
A			

REV: DESCRIPTION: BY: DATE:

DEALER:

PROJECT:

SKU: RPWM-UNV-64

PART NO: 0006-000-00F

DESCRIPTION: UNIVERESAL MOUNT ASSEMBLY

SIZE: B DATE: 9/18/2023 DRAWN: GS CHECKED:

DWG. ID: RPWM-32MAXBF-XMS-UNV

JOB NO: SCALE: 1:6 SHEET: 4 OF 4 REVISION: F