

This drawing contains proprietary information owned or controlled by RPVisual Solutions and must not be used or disclosed without prior written authorization

DIMENSIONS ARE IN INCHES  
 TOLERANCES ARE:

| FRACTIONS    | DECIMALS                     | ANGLES                  |
|--------------|------------------------------|-------------------------|
| X/X : ± 1/32 | .XX : ± .03<br>.XXX : ± .010 | X : ± .5<br>.XX : ± .20 |

**APPROVED FOR FABRICATION**

SIGNATURE: \_\_\_\_\_

DATE: \_\_\_\_\_

NOTES:

1. FINISH: FLAT BLACK POWDER COAT
2. APPROXIMATE WEIGHT: 56

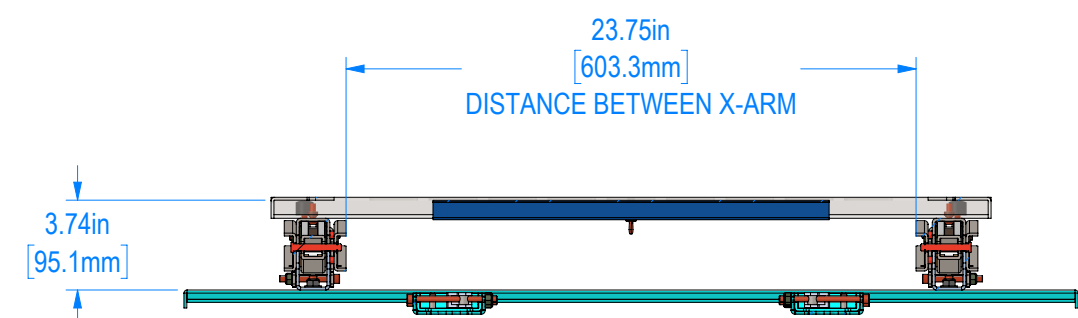

SECTION A-A

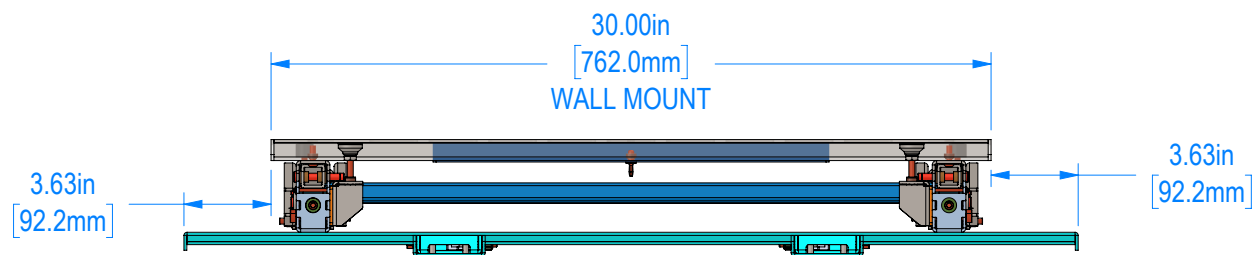

WALL MOUNT

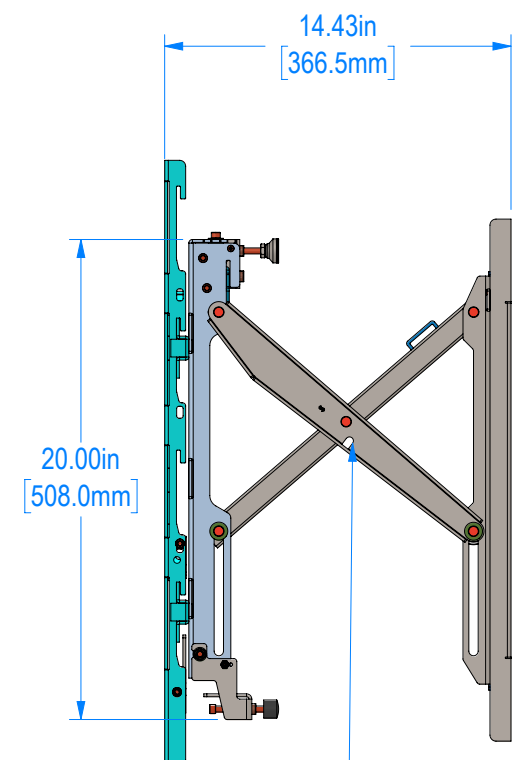

OPEN LOCK  
 SEE SHEET 2  
 FOR DETAIL

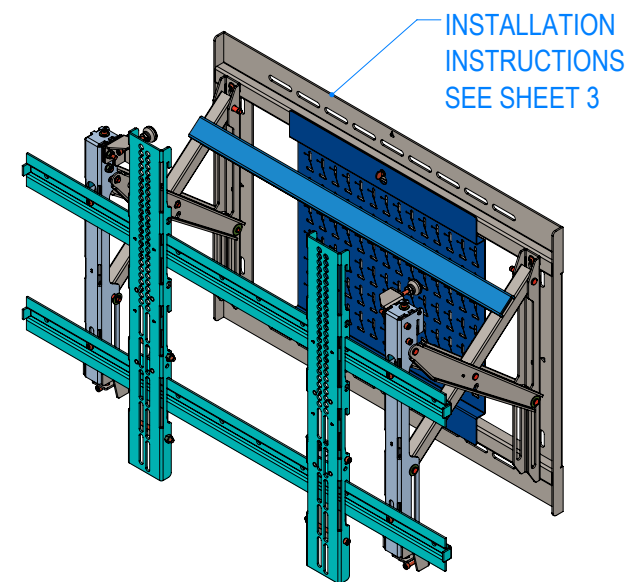

FRONT ISO VIEW

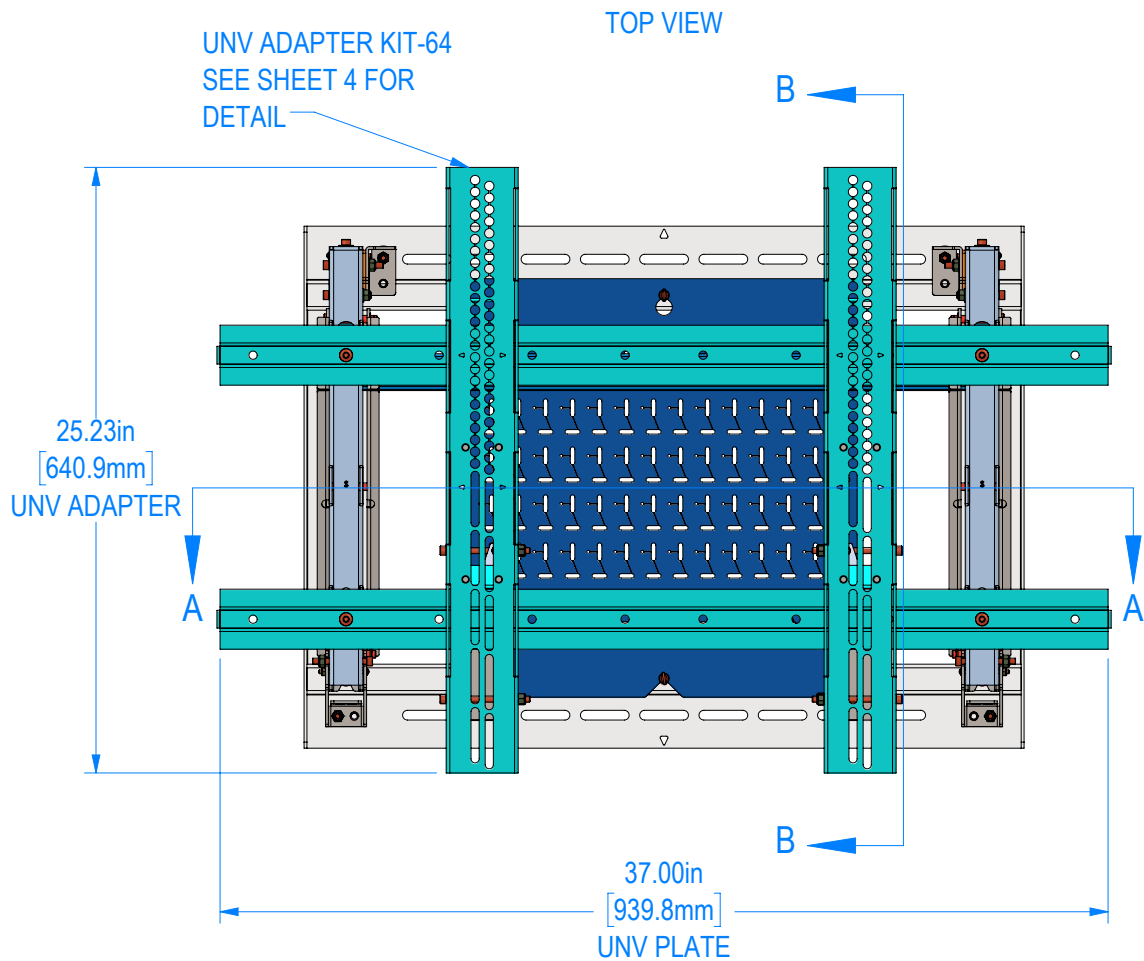

FRONT VIEW

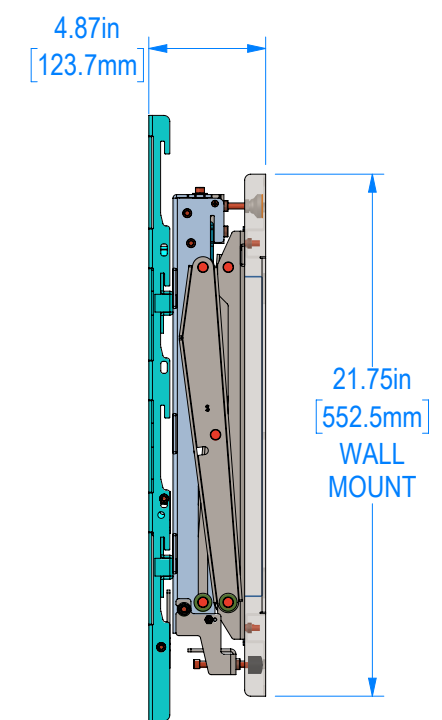

SIDE VIEW

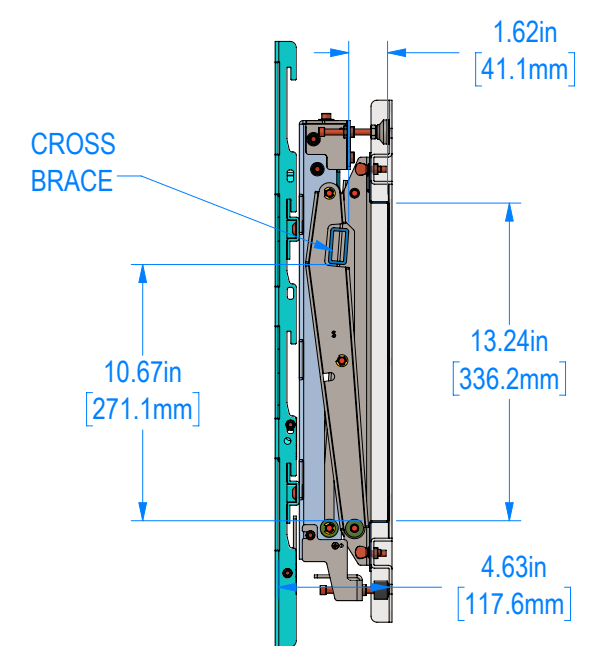

SECTION B-B

|         |              |     |       |
|---------|--------------|-----|-------|
| G       |              |     |       |
| F       |              |     |       |
| E       |              |     |       |
| C       |              |     |       |
| B       |              |     |       |
| A       |              |     |       |
| REV:    | DESCRIPTION: | BY: | DATE: |
| DEALER: |              |     |       |

PROJECT: \_\_\_\_\_

SKU: **RPWM-W32B-XMS-UNV**

PART NO: **0002-291-00**

DESCRIPTION: **Wallmate W32B Surface mount system with Universal Mount**

|                |                         |                   |          |
|----------------|-------------------------|-------------------|----------|
| SIZE: <b>B</b> | DATE: <b>04/02/2026</b> | DRAWN: <b>CAN</b> | CHECKED: |
|----------------|-------------------------|-------------------|----------|

DWG. ID: **RPWM-W32B-XMS-UNV.1**

|         |                      |           |
|---------|----------------------|-----------|
| JOB NO: | SCALE: <b>1:8</b>    | REVISION: |
|         | SHEET: <b>1 OF 4</b> |           |

This drawing contains proprietary information owned or controlled by RPVisual Solutions and must not be used or disclosed without prior written authorization

DIMENSIONS ARE IN INCHES  
TOLERANCES ARE:  
FRACTIONS DECIMALS ANGLES  
X/X : ± 1/32 .XX : ± .03 .X : ± .5  
.XXX : ± .010 .XX : ± .20

APPROVED FOR FABRICATION

SIGNATURE:

DATE:

NOTES:

1. FINISH: FLAT BLACK POWDER COAT
2. APPROXIMATE WEIGHT: 40

|         |              |     |       |
|---------|--------------|-----|-------|
| G       |              |     |       |
| F       |              |     |       |
| E       |              |     |       |
| C       |              |     |       |
| B       |              |     |       |
| A       |              |     |       |
| REV:    | DESCRIPTION: | BY: | DATE: |
| DEALER: |              |     |       |

PROJECT:

SKU: RPWM-W32B-XMS-UNV

PART NO: 0002-291-00

DESCRIPTION: Wallmate W32B Surface mount system with Universal Mount

SIZE: B DATE: 04/02/2026 DRAWN: CAN CHECKED:

DWG. ID: RPWM-W32B-XMS-UNV.2

JOB NO: SCALE: 1:6 SHEET: 2 OF 4 REVISION:

Ø 0.63in KEYHOLE  
[15.9mm]  
X2, UPPER X-ARM

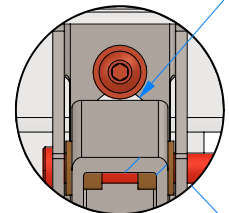

DETAIL K  
SCALE 1 : 2

WALL MOUNT  
LOCATION

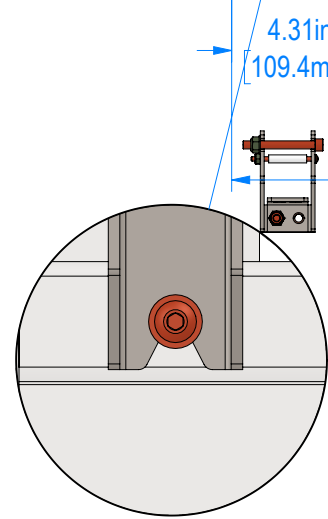
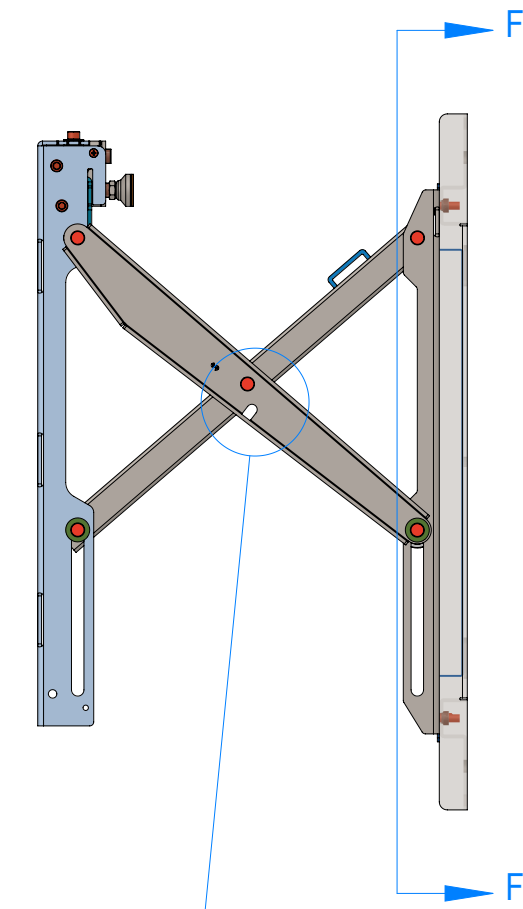
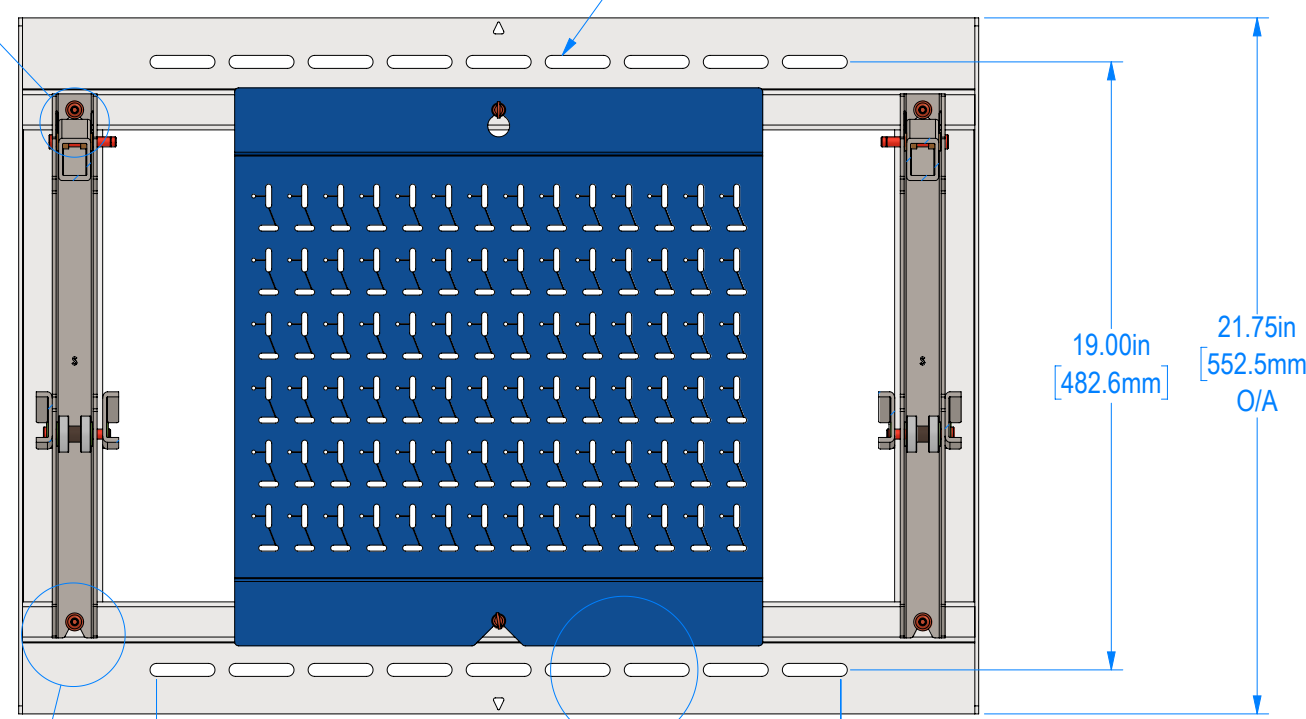

DETAIL H  
SCALE 1 : 2

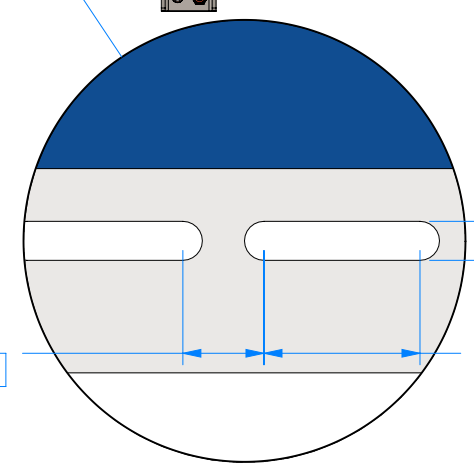

DETAIL G  
SCALE 1 : 2

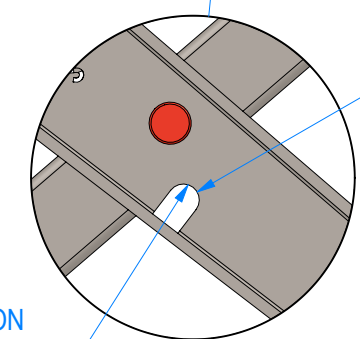

DETAIL E  
SCALE 1 : 2

USE THIS LOCATION  
TO LOCK X-ARM  
IN OPEN POSITION

- ESTIMATED TOTAL SYSTEM WEIGHT (NOT INCLUDING DISPLAY) = 58 LBS
- ATTACH TO WALL REQUIRED BY OTHERS. TYPE & FREQUENCY OF ATTACHMENT TO BE DETERMINED BY STRUCTURAL ENGINEERS / LOCAL CONTRACTORS

SECTION F-F

This drawing contains proprietary information owned or controlled by RPVisual Solutions and must not be used or disclosed without prior written authorization

DIMENSIONS ARE IN INCHES

| TOLERANCES ARE: |                              |                         |
|-----------------|------------------------------|-------------------------|
| FRACTIONS       | DECIMALS                     | ANGLES                  |
| X/X : ± 1/32    | .XX : ± .03<br>.XXX : ± .010 | X : ± .5<br>.XX : ± .20 |

**APPROVED FOR FABRICATION**

SIGNATURE: \_\_\_\_\_

DATE: \_\_\_\_\_

NOTES:

1. FINISH: FLAT BLACK POWDER COAT
2. APPROXIMATE WEIGHT: 56

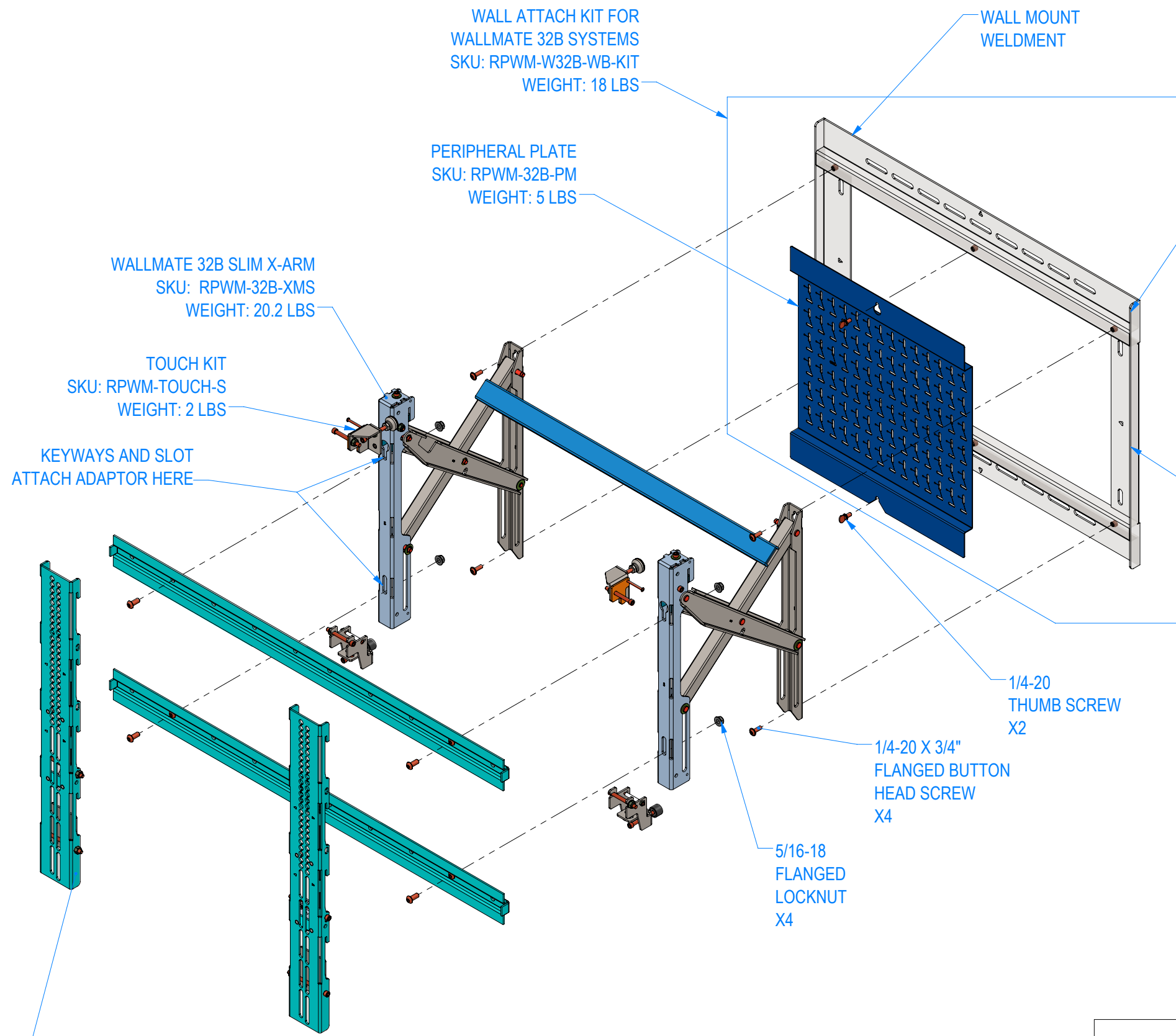

**IMPORTANT**

- LEVEL AND PLUMB WALL MOUNT WELDMENT

**IMPORTANT**

- HARDWARE TO ATTACH TO WALL BY OTHERS
- TYPE AND QUANTITY BY STRUCTURAL ENGINEER

- INSTALLATION NOTES:**
1. WALLMATE W32B-XMS-UNV REQUIRES FLAT WALL TO HOLD 250LBS CAPACITY
  2. VERIFY FASTENING METHOD WITH STRUCTURAL ENGINEER PRIOR TO INSTALLATION
  3. VERIFY WALL STRENGTH PRIOR TO INSTALLATION

|   |  |  |  |
|---|--|--|--|
| G |  |  |  |
| F |  |  |  |
| E |  |  |  |
| C |  |  |  |
| B |  |  |  |
| A |  |  |  |

REV: DESCRIPTION: \_\_\_\_\_ BY: \_\_\_\_\_ DATE: \_\_\_\_\_

DEALER: \_\_\_\_\_

PROJECT: \_\_\_\_\_

SKU: RPWM-W32B-XMS-UNV

PART NO: 0002-291-00

DESCRIPTION: Wallmate W32B Surface mount system with Universal Mount

|         |                  |            |          |
|---------|------------------|------------|----------|
| SIZE: B | DATE: 04/02/2026 | DRAWN: CAN | CHECKED: |
|---------|------------------|------------|----------|

DWG. ID: RPWM-W32B-XMS-UNV.3

|         |               |           |
|---------|---------------|-----------|
| JOB NO: | SCALE: 1:8    | REVISION: |
|         | SHEET: 3 OF 4 |           |

**NOTE TO CONTRACTOR:**  
 USE SUPPLIED HARDWARE WITH CAUTION:  
 - SCREWS CAN EXCEED DISPLAY INSERT LENGTH  
 - VERIFY INSERT LENGTH WITH DISPLAY  
 MANUFACTURER PRIOR TO USE

DISPLAY MOUNTING HARDWARE PROVIDED BY RPV:  
 QTY: 4 / UNIT - M6 X 16mm FLANGED SBHCS ALLOY  
 QTY: 4 / UNIT - M8 X 16mm FLANGED SBHCS ALLOY  
 QTY: 4 / UNIT - M8 X 20mm FLANGED SBHCS ALLOY  
 QTY: 4 / UNIT - M8 X 45mm SBHCS ALLOY  
 QTY: 4 / UNIT - 5/16" ID X 3/4" OD FLAT WASHER

This drawing contains proprietary information owned or controlled by RPVisual Solutions and must not be used or disclosed without prior written authorization

DIMENSIONS ARE IN INCHES  
 TOLERANCES ARE:  
 FRACTIONS DECIMALS ANGLES  
 X/X : ± 1/32 .XX : ± .03 .X : ± .5  
 .XXX : ± .010 .XX : ± .20

**APPROVED FOR FABRICATION**  
 SIGNATURE:

DATE:

NOTES:

1. FINISH: FLAT BLACK POWDER COAT
2. APPROXIMATE WEIGHT: 16

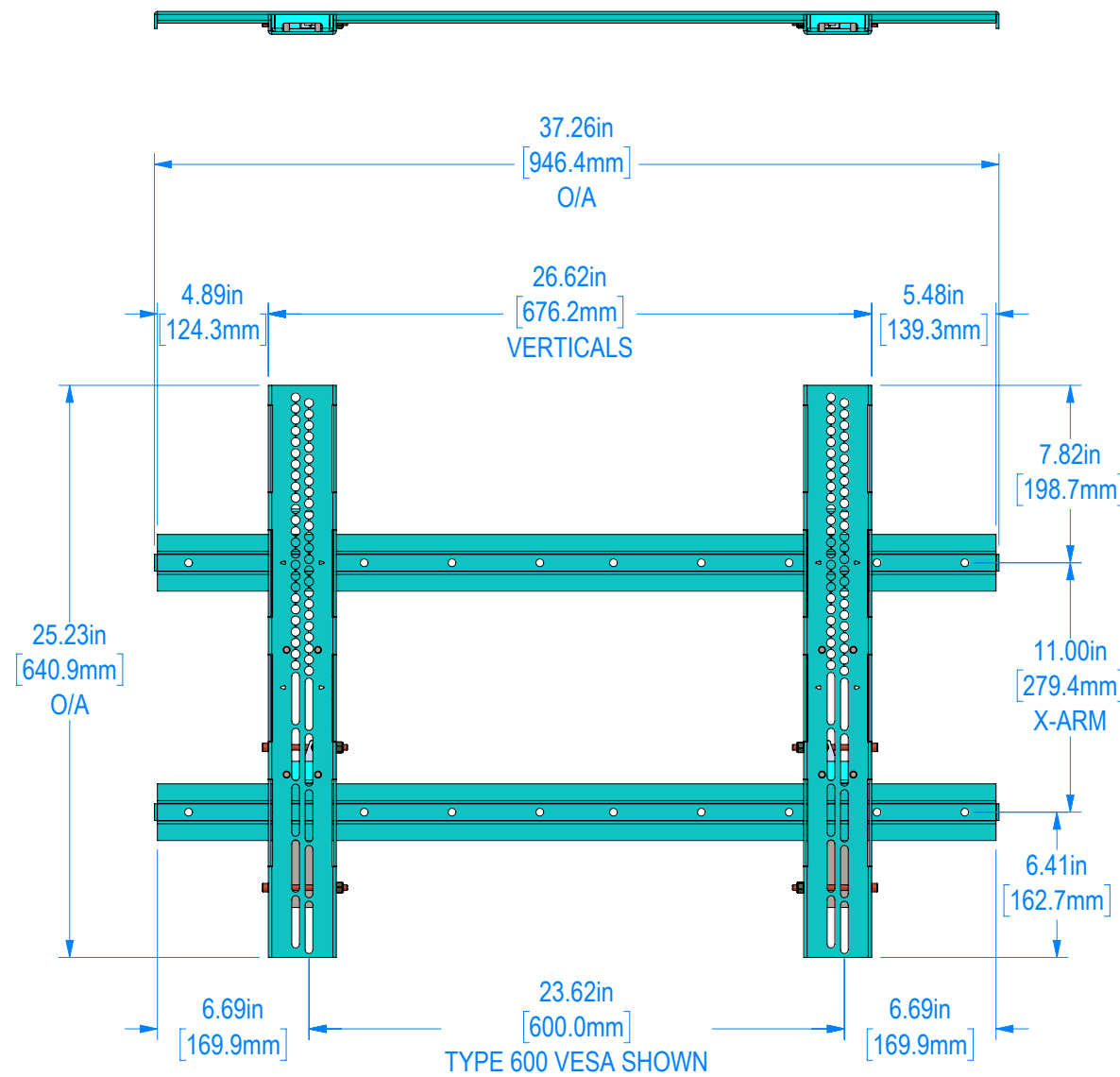

←  
**DISPLAY THIS SIDE**

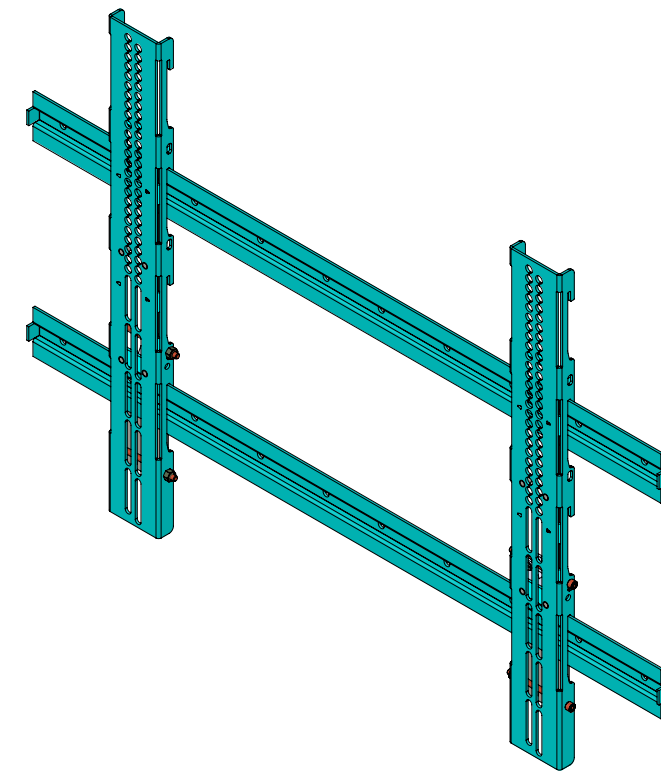

|   |  |  |  |
|---|--|--|--|
| G |  |  |  |
| F |  |  |  |
| E |  |  |  |
| C |  |  |  |
| B |  |  |  |
| A |  |  |  |

REV: DESCRIPTION: BY: DATE:

DEALER:

PROJECT:

SKU: RPWM-UNV-64

PART NO: 0006-000-00F

DESCRIPTION: Universal Mount Assembly

|         |                  |            |          |
|---------|------------------|------------|----------|
| SIZE: B | DATE: 04/02/2026 | DRAWN: CAN | CHECKED: |
|---------|------------------|------------|----------|

DWG. ID: RPWM-W32B-XMS-UNV.4

|         |               |             |
|---------|---------------|-------------|
| JOB NO: | SCALE: 1:8    | REVISION: F |
|         | SHEET: 4 OF 4 |             |