

This drawing contains proprietary information owned or controlled by RPVisual Solutions and must not be used or disclosed without prior written authorization

DIMENSIONS ARE IN INCHES
TOLERANCES ARE:
FRACTIONS: XX: ±.03 ANGLES: X: ±.5
X/X: ± 1/32 .XXX: ±.010 .XX: ±.20

APPROVED FOR FABRICATION

SIGNATURE: _____

DATE: _____

NOTES:

1. FINISH: SEMI-GLOSS BLACK POWDER COAT
2. APPROXIMATE WEIGHT: 152

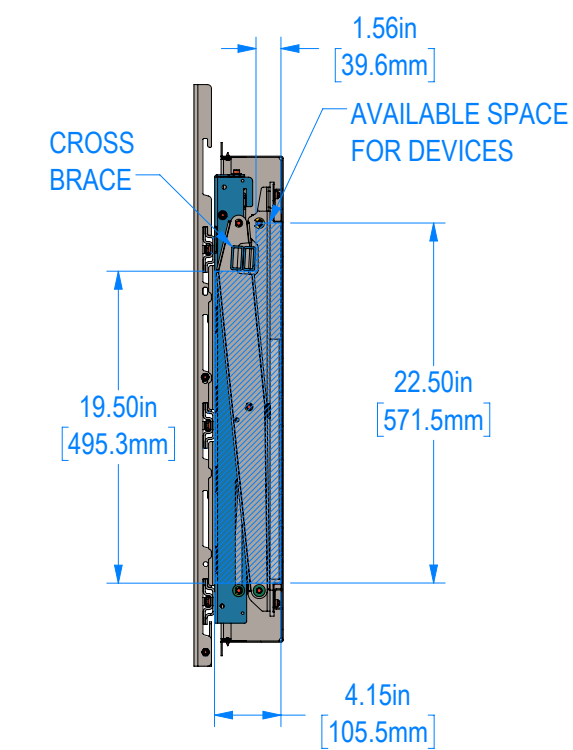
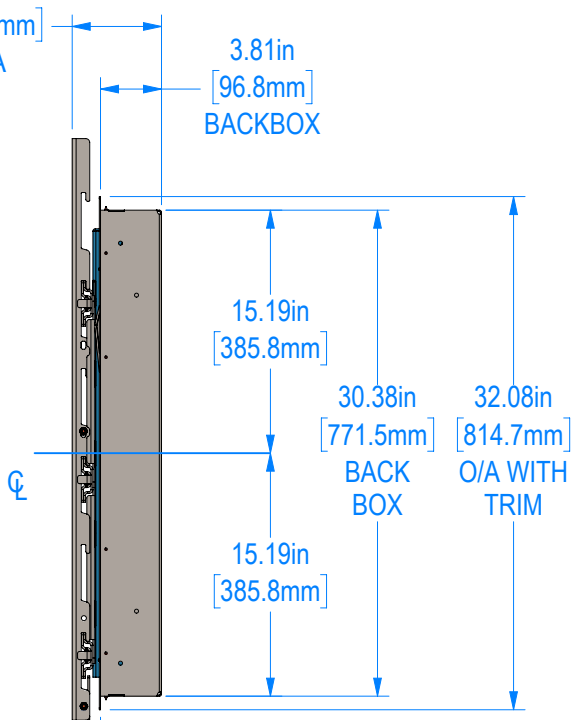
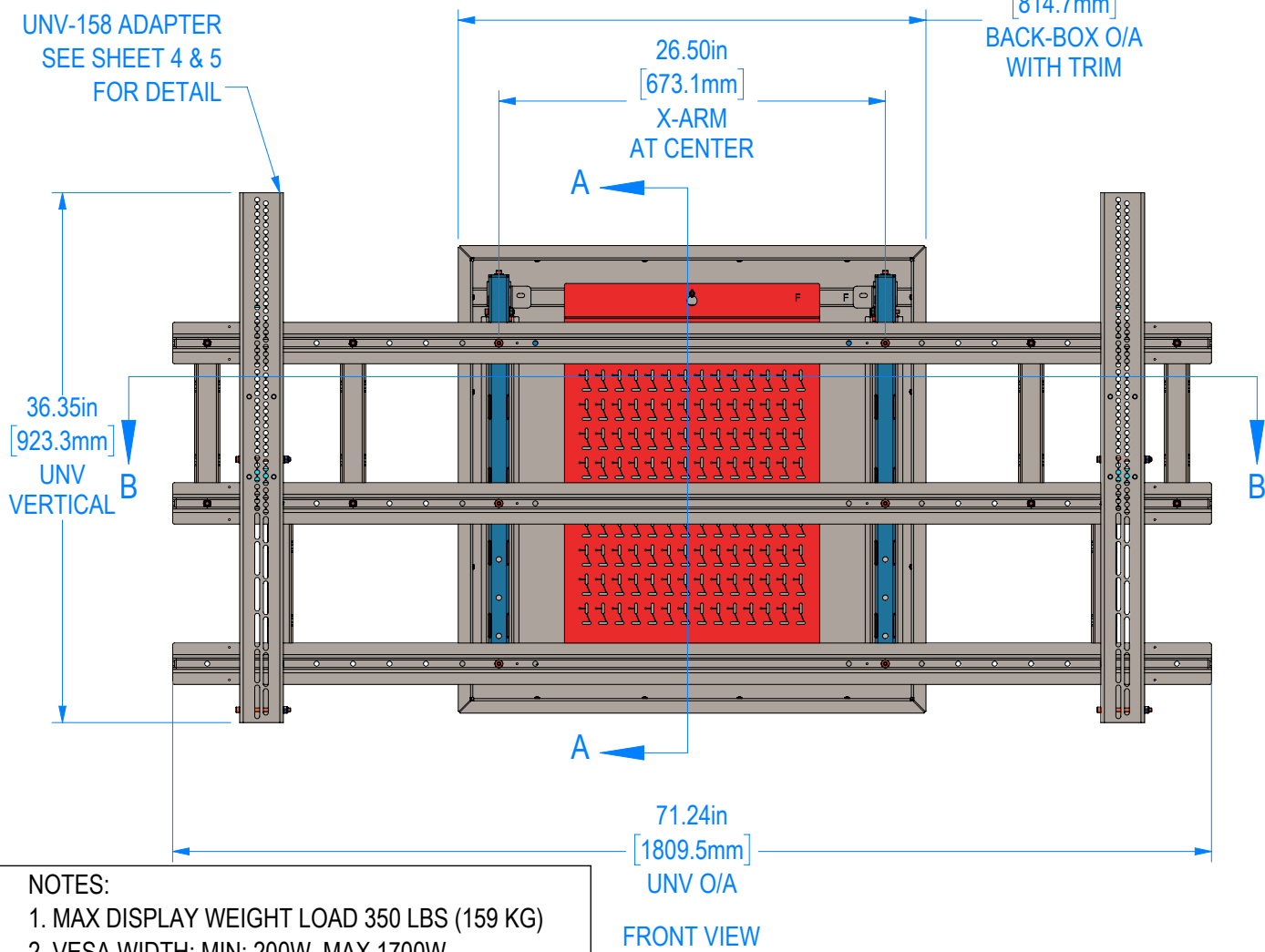
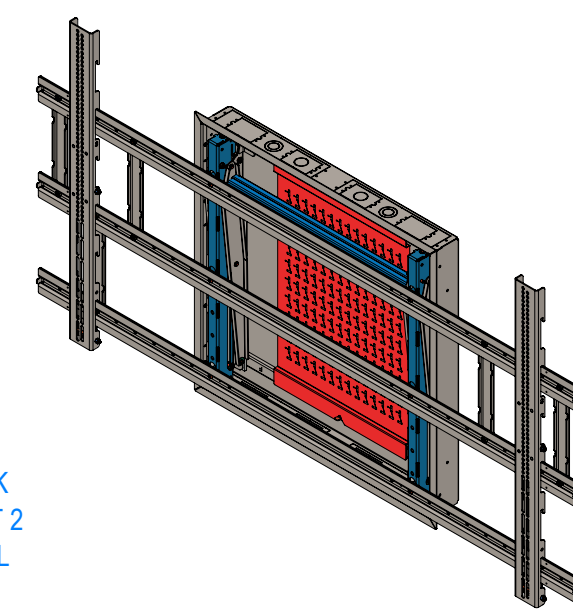
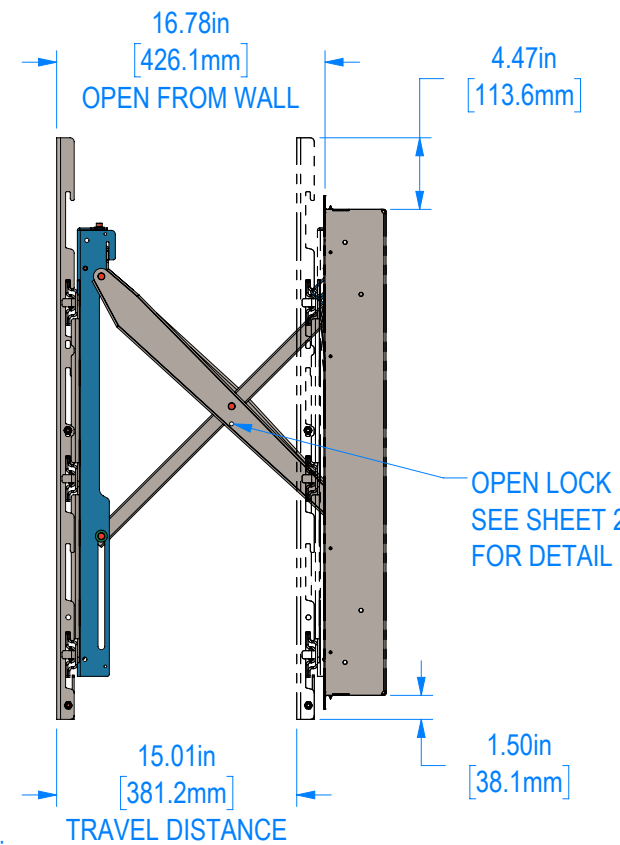
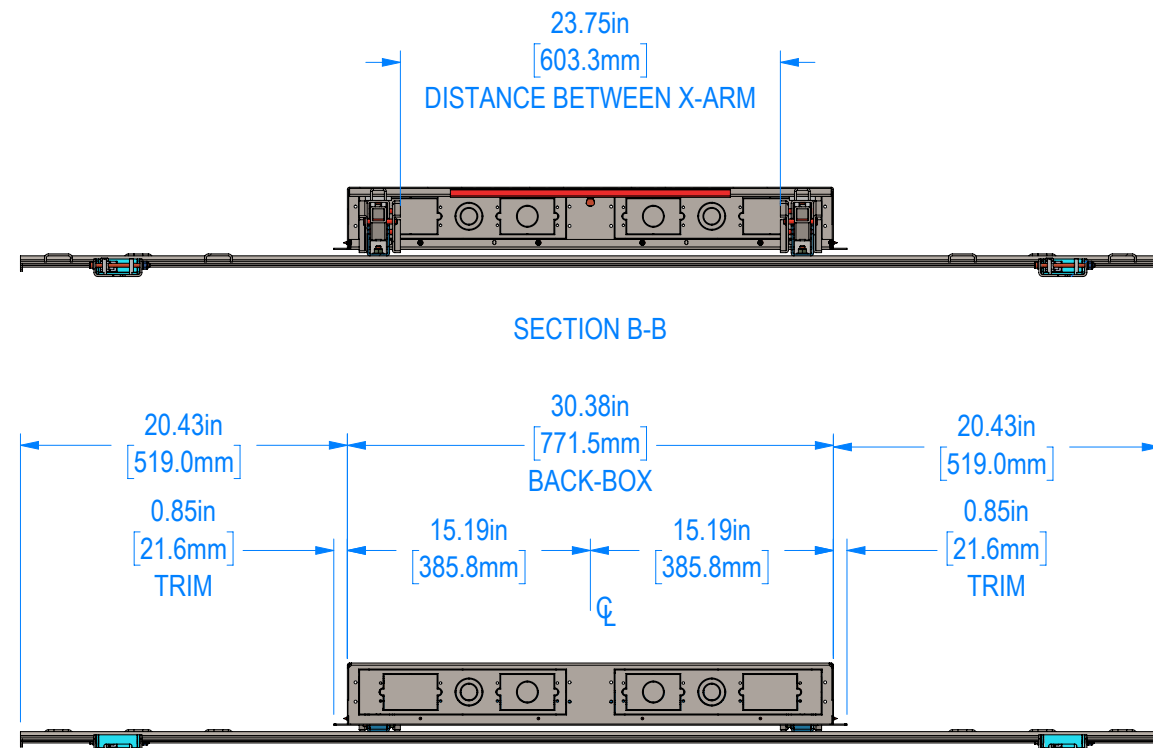

- NOTES:**
1. MAX DISPLAY WEIGHT LOAD 350 LBS (159 KG)
 2. VESA WIDTH: MIN: 200W, MAX 1700W
 3. VESA HEIGHT: MIN: 200H, MAX 800H

G			
F			
E			
C			
B			
A			
REV:	DESCRIPTION:	BY:	DATE:
DEALER:			
PROJECT:			
SKU: RPWM-32MAXBF-XMR-UNV-158			
PART NO: 00080-005.01.00			
DESCRIPTION: Large Display Universal Mount-Pullout Wallmate 32MAXBF kit			
SIZE: B	DATE: 05/08/2026	DRAWN: CAN	CHECKED: XX
DWG. ID: RPWM-32MAXBF-XMR-UNV-158 SALES.1			
JOB NO:	SCALE: 1:12	REVISION: A	
	SHEET: 1 OF 5		

This drawing contains proprietary information owned or controlled by RPVisual Solutions and must not be used or disclosed without prior written authorization

DIMENSIONS ARE IN INCHES

TOLERANCES ARE:		
FRACTIONS	DECIMALS	ANGLES
X/X : ± 1/32	.XX : ± .03	.X : ± .5
	.XXX : ± .010	.XX : ± .20

APPROVED FOR FABRICATION

SIGNATURE: _____

DATE: _____

NOTES:

1. FINISH: SEMI-GLOSS BLACK POWDER COAT
2. APPROXIMATE WEIGHT: 152

G			
F			
E			
C			
B			
A			

REV: DESCRIPTION: _____ BY: _____ DATE: _____
DEALER: _____

PROJECT: _____

SKU: **RPWM-32MAXBF-XMR-UNV-158**

PART NO: **00080-005.01.00**

DESCRIPTION: **Large Display Universal Mount- Pullout Wallmate 32MAXBF kit**

SIZE: B	DATE: 05/08/2026	DRAWN: CAN	CHECKED: XX
----------------	-------------------------	-------------------	--------------------

DWG. ID: **RPWM-32MAXBF-XMR-UNV-158 SALES.2**

JOB NO: _____	SCALE: 1:8	REVISION: _____
	SHEET: 2 OF 5	A

KEYHOLE X2
UPPER X-ARM

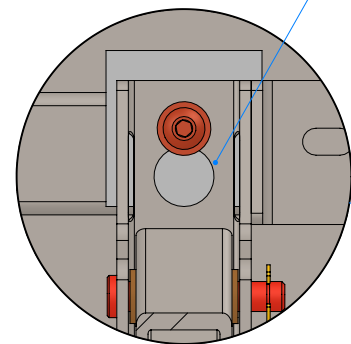

DETAIL D
SCALE 1 : 2

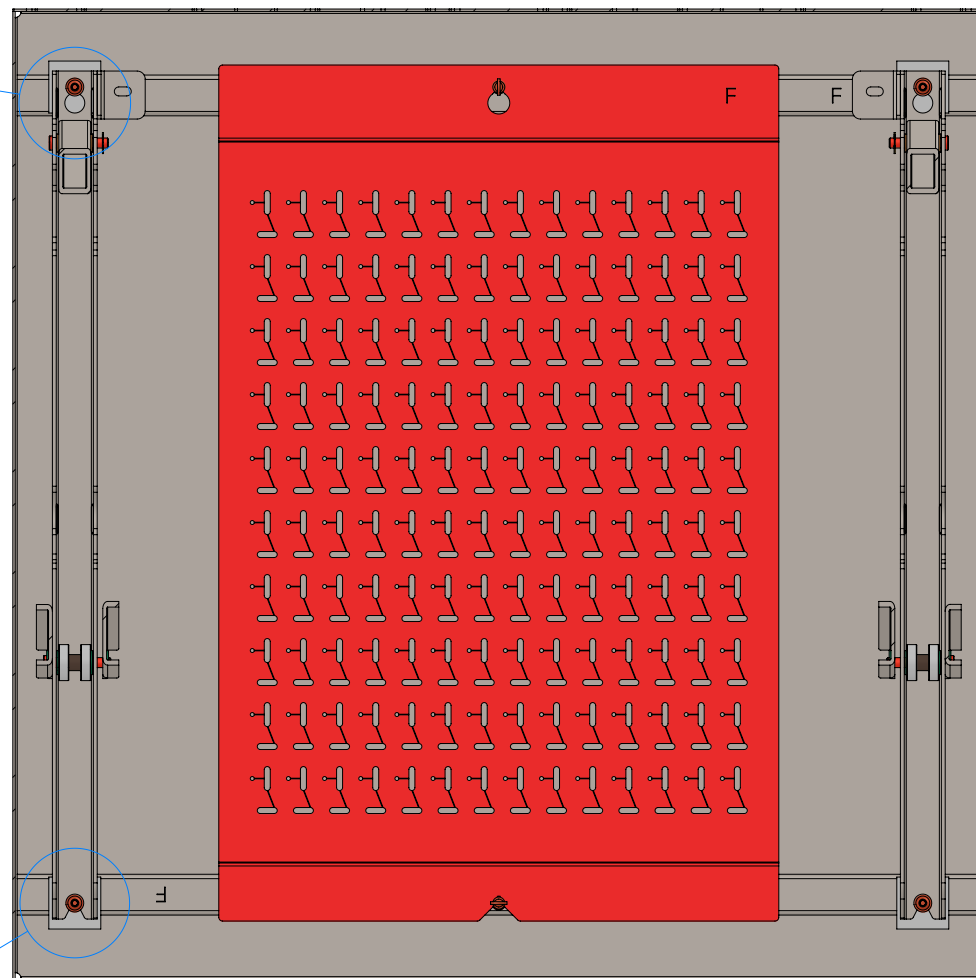

SECTION C-C
SCALE 1 : 6

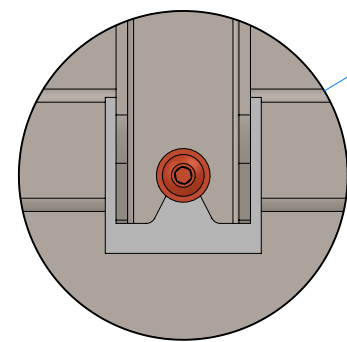

DETAIL E
SCALE 1 : 2

USE THIS LOCATION
TO LOCK X-ARM
IN OPEN POSITION

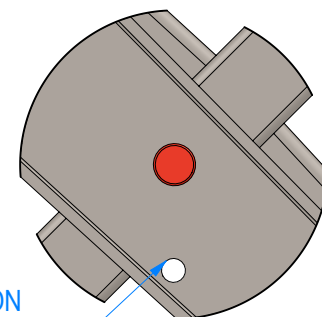

DETAIL F
SCALE 1 : 2

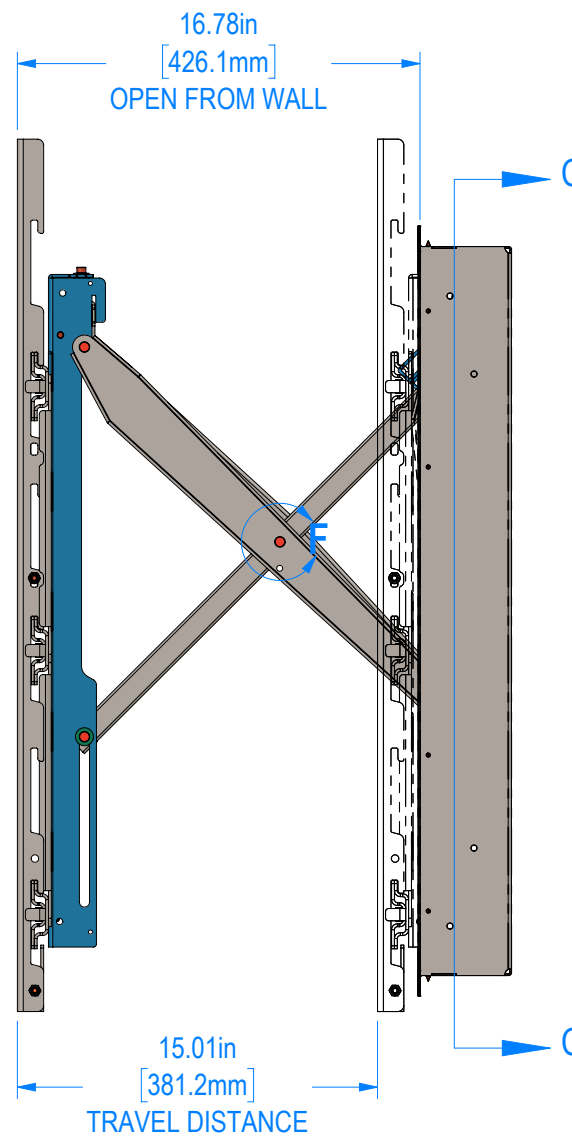

SIDE VIEW

This drawing contains proprietary information owned or controlled by RPVisual Solutions and must not be used or disclosed without prior written authorization

DIMENSIONS ARE IN INCHES
TOLERANCES ARE:

FRACTIONS	DECIMALS	ANGLES
X/X : ± 1/32	.XX : ± .03 .XXX : ± .010	.X : ± .5 .XX : ± .20

APPROVED FOR FABRICATION
SIGNATURE: _____

DATE: _____

NOTES:
1. FINISH: SEMI-GLOSS BLACK POWDER COAT
2. APPROXIMATE WEIGHT: 152

G			
F			
E			
C			
B			
A			
REV:	DESCRIPTION:	BY:	DATE:
DEALER:			

PROJECT: _____

SKU: RPWM-32MAXBF-XMR-UNV-158

PART NO: 00080-005.01.00

DESCRIPTION: Large Display Universal Mount-Pullout Wallmate 32MAXBF kit

SIZE: B	DATE: 05/08/2026	DRAWN: CAN	CHECKED: XX
---------	------------------	------------	-------------

DWG. ID: RPWM-32MAXBF-XMR-UNV-158 SALES.3

JOB NO:	SCALE: 1:10	REVISION: A
	SHEET: 3 OF 5	

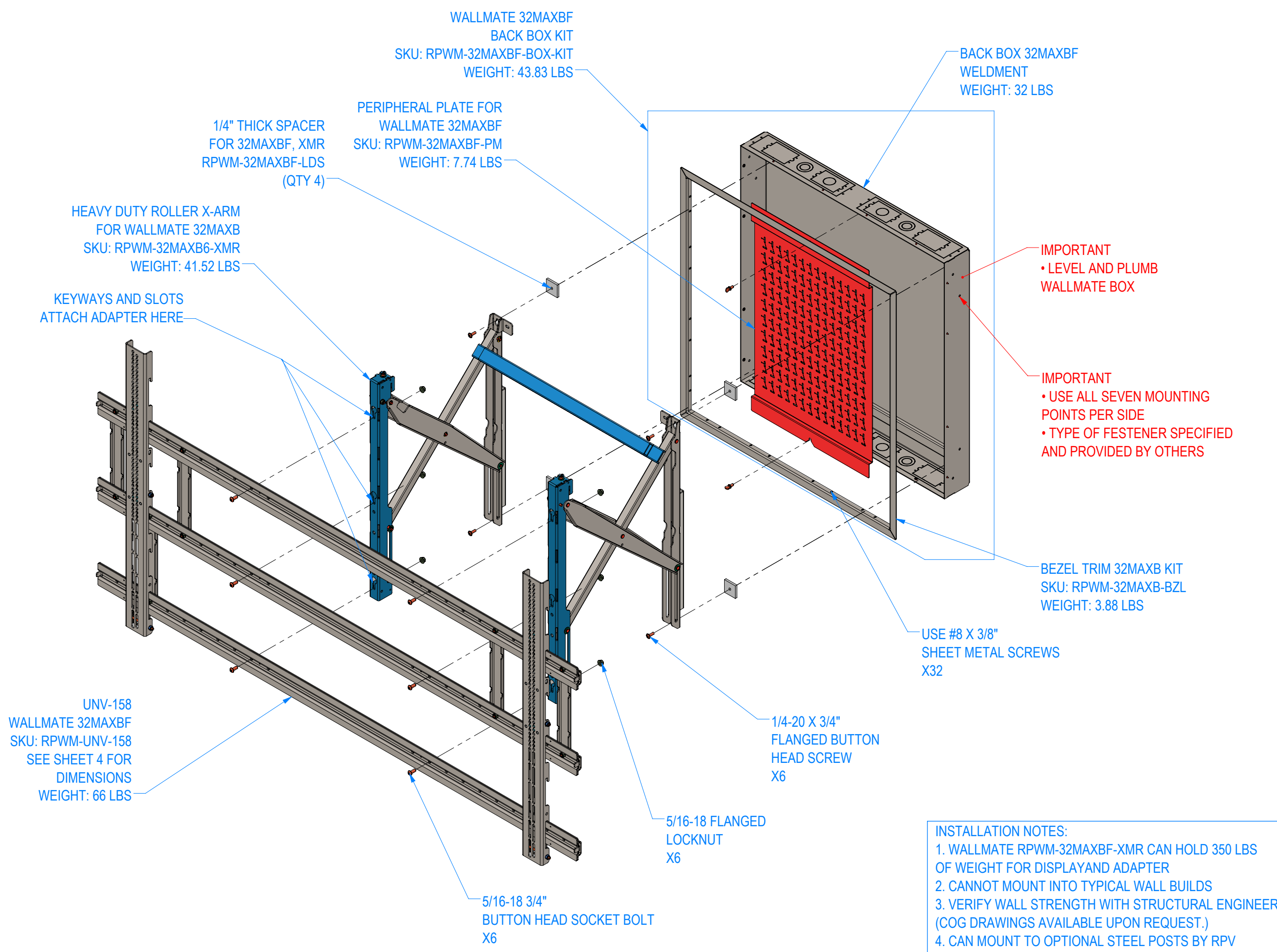

INSTALLATION NOTES:
1. WALLMATE RPWM-32MAXBF-XMR CAN HOLD 350 LBS OF WEIGHT FOR DISPLAY AND ADAPTER
2. CANNOT MOUNT INTO TYPICAL WALL BUILDS
3. VERIFY WALL STRENGTH WITH STRUCTURAL ENGINEER. (COG DRAWINGS AVAILABLE UPON REQUEST.)
4. CAN MOUNT TO OPTIONAL STEEL POSTS BY RPV (CALL FOR DETAILS)
5. USE ALL FASTENING POINTS ON BOTH SIDES OF BOX

NOTE TO CONTRACTOR:
 USE SUPPLIED HARDWARE WITH CAUTION:
 - SCREWS CAN EXCEED DISPLAY INSERT LENGTH
 - VERIFY INSERT LENGTH WITH DISPLAY
 MANUFACTURER PRIOR TO USE

DISPLAY MOUNTING HARDWARE PROVIDED BY RPV:
 QTY: 4 / UNIT - M6 X 16mm FLANGED SBHCS ALLOY
 QTY: 4 / UNIT - M8 X 16mm, M8 X 20mm FLANGED SBHCS ALLOY
 QTY: 4 / UNIT - M8 X 40mm SBHCS ALLOY
 QTY: 4 / UNIT - 5/16" ID X 3/4" OD FLAT WASHER

This drawing contains proprietary information owned or controlled by RPVisual Solutions and must not be used or disclosed without prior written authorization

DIMENSIONS ARE IN INCHES
TOLERANCES ARE:
FRACTIONS **DECIMALS** **ANGLES**
 X/X : ± 1/32 .XX : ± .03 .X : ± .5
 .XXX : ± .010 .XX : ± .20

APPROVED FOR FABRICATION
 SIGNATURE: _____

DATE: _____

NOTES:

1. FINISH: SEMI-GLOSS BLACK POWDER COAT
2. APPROXIMATE WEIGHT: 67 LBS

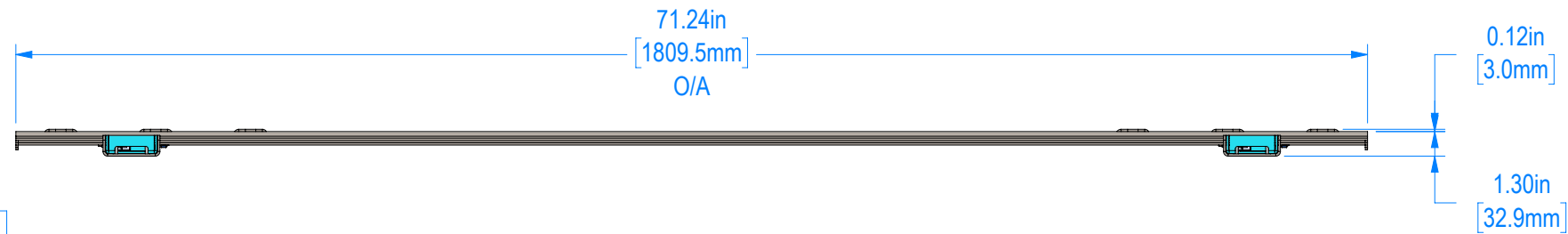

MAXIMUM VESA PATTERN:
 1700 X 800
MINIMUM VESA PATTERN:
 200 X 200

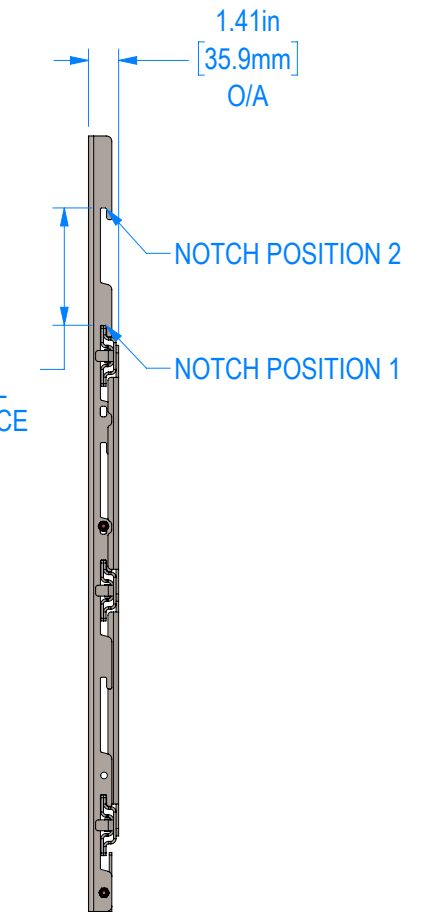
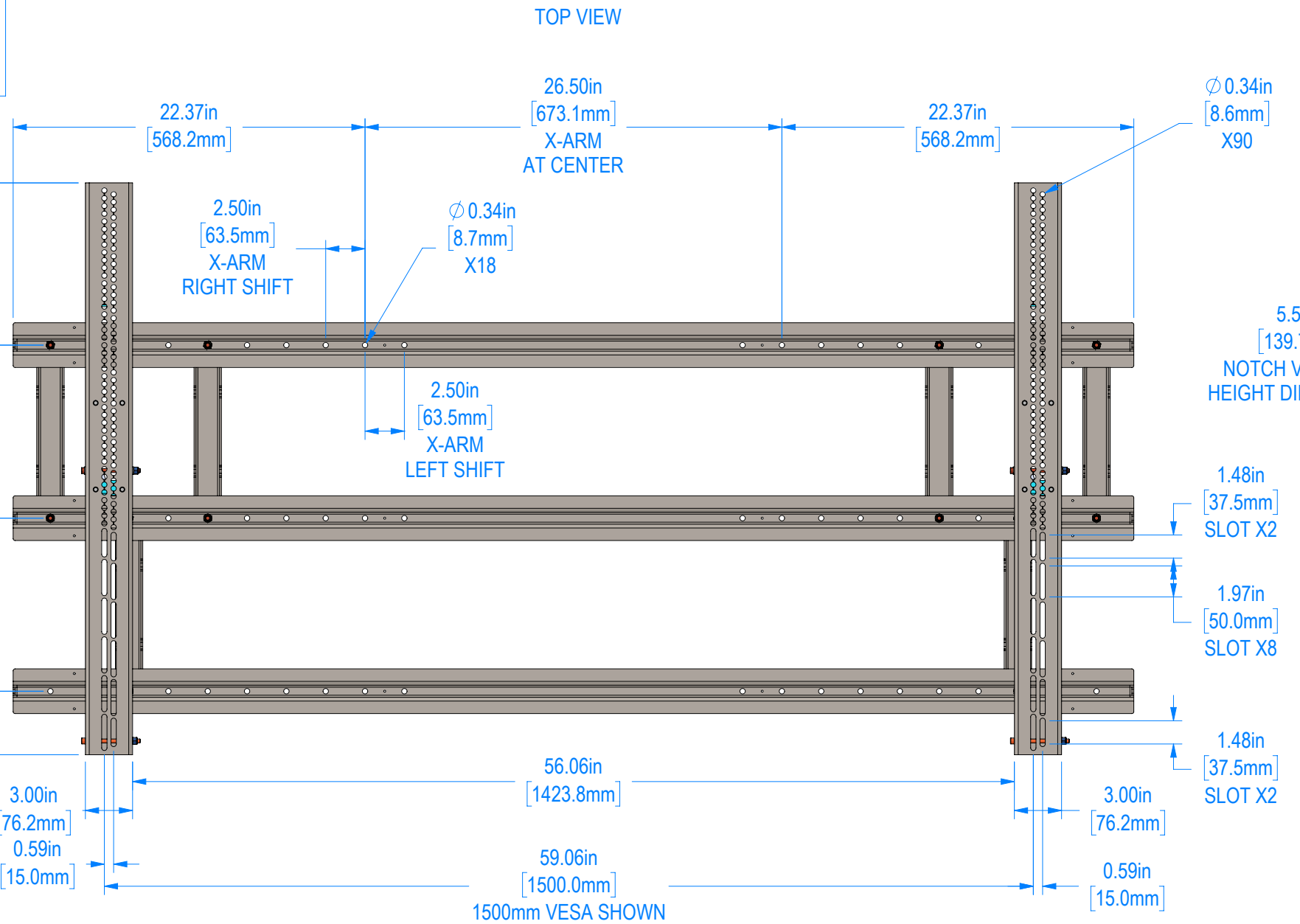

NOTE:
 NOTCH POSITION 1 SHOWN, SEE SHEET 5 FOR NOTCH POSITION 2

G			
F			
E			
C			
B			
A			
REV:	DESCRIPTION:	BY:	DATE:
DEALER:			

PROJECT: _____
 SKU: RPWM-UNV-158
 PART NO: 00080-005_01-00-B
 DESCRIPTION: Walmart B6-XMR UNIVERSAL MOUNT

SIZE: B	DATE: 05/08/2026	DRAWN: CAN	CHECKED: XX
DWG. ID: RPWM-32MAXBF-XMR-UNV-158 SALES.4			
JOB NO:	SCALE: 1:9	REVISION: B	
	SHEET: 4 OF 5		

NOTE TO CONTRACTOR:
 USE SUPPLIED HARDWARE WITH CAUTION:
 - SCREWS CAN EXCEED DISPLAY INSERT LENGTH
 - VERIFY INSERT LENGTH WITH DISPLAY
 MANUFACTURER PRIOR TO USE

DISPLAY MOUNTING HARDWARE PROVIDED BY RPV:
 QTY: 4 / UNIT - M6 X 16mm FLANGED SBHCS ALLOY
 QTY: 4 / UNIT - M8 X 16mm, M8 X 20mm FLANGED SBHCS ALLOY
 QTY: 4 / UNIT - M8 X 40mm SBHCS ALLOY
 QTY: 4 / UNIT - 5/16" ID X 3/4" OD FLAT WASHER

This drawing contains proprietary information owned or controlled by RPVisual Solutions and must not be used or disclosed without prior written authorization.
 DIMENSIONS ARE IN INCHES
 TOLERANCES ARE:
 FRACTIONS: XX: ± .03 ANGLES: X: ± .5
 X/X: ± 1/32 .XXX: ± .010 .XX: ± .20

APPROVED FOR FABRICATION
 SIGNATURE:

DATE:

NOTES:
 1. FINISH: SEMI-GLOSS BLACK POWDER COAT
 2. APPROXIMATE WEIGHT: 67 LBS

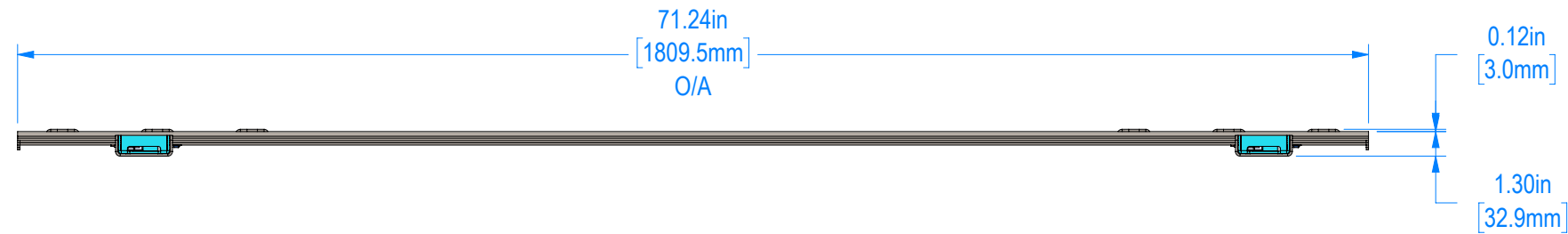

MAXIMUM VESA PATTERN:
 1700 X 800
 MINIMUM VESA PATTERN:
 200 X 200

←
DISPLAY THIS SIDE

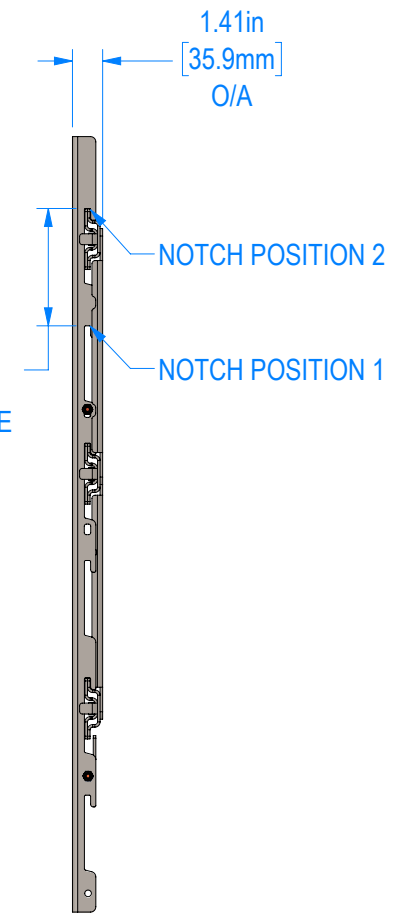
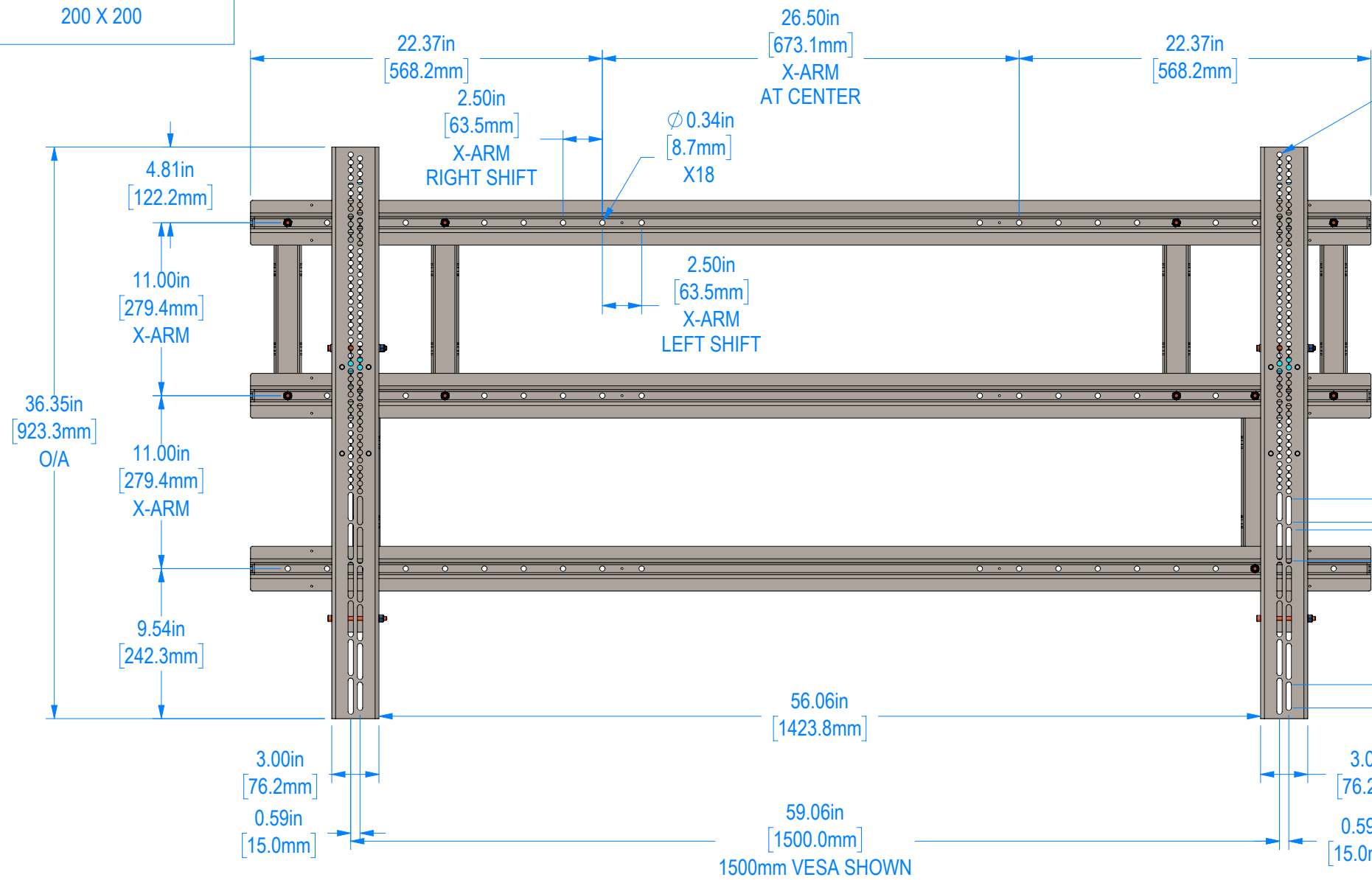

NOTE:
 NOTCH POSITION 2 SHOWN, SEE SHEET 4 FOR NOTCH POSITION 1

G			
F			
E			
C			
B			
A			
REV:	DESCRIPTION:	BY:	DATE:
DEALER:			

PROJECT:
 SKU: RPWM-UNV-158
 PART NO: 00080-005_01-00-B
 DESCRIPTION: Walmart B6-XMR UNIVERSAL MOUNT

SIZE: B	DATE: 05/08/2026	DRAWN: CAN	CHECKED: XX
DWG. ID: RPWM-32MAXBF-XMR-UNV-158 SALES.5			
JOB NO:	SCALE: 1:9	REVISION: B	
	SHEET: 5 OF 5		